

ARMY TM 11-6625-2921-24P
NAVY E2137-BV-PLL-060/5103SG-1054
AIR FORCE TO 33A1-8-883-4

TECHNICAL MANUAL

**ORGANIZATIONAL, DIRECT SUPPORT AND
GENERAL SUPPORT MAINTENANCE
REPAIR PARTS AND SPECIAL TOOLS LIST
(INCLUDING DEPOT MAINTENANCE REPAIR
PARTS AND SPECIAL TOOLS)**

F O R

GENERATOR, SIGNAL

SG-1054/G

(NSN6625-00-137-7738)

DEPARTMENTS OF THE ARMY, THE NAVY, AND THE AIR FORCE

15 NOVEMBER 1982

TECHNICAL MANUAL
 No. 11-6625-2921-24P
 TECHNICAL MANUAL
 E2137-BV-PLL-060/5103SG-1054
 TECHNICAL ORDER
 No. T033A1-8-883-4



DEPARTMENTS OF THE ARMY,
 THE NAVY, AND THE AIR FORCE
 WASHINGTON, DC, 15 November 1982

ORGANIZATIONAL, DIRECT SUPPORT, AND GENERAL SUPPORT
 MAINTENANCE REPAIR PARTS AND SPECIAL TOOLS LIST
 (INCLUDING DEPOT MAINTENANCE REPAIR PARTS
 AND SPECIAL TOOLS)
 FOR
 GENERATOR, SIGNAL SG-1054/G
 (NSN 6625-00-137-7738)

Current as of 4 June 1982

REPORTING ERRORS AND RECOMMENDING IMPROVEMENTS
 You can help improve this manual. If you find any mistakes or if you know of a way to improve the procedures, please let us know. Mail your letter, DA Form 2028 (Recommended Changes to Publications and Blank Forms), or DA Form 3028-2 located in back of this manual direct to Commander, US Army Communications-Electronics Command and Fort Monmouth, ATTN: DR-SEL-ME-MP, Fort Monmouth, New Jersey 07703.
 For Air Force, submit AFTO Form 22 (Technical Order System Publication Improvement Report and Reply) in accordance with paragraph 6-5, Section VI, T.O. 00-5-1. Forward direct to prime ALC/MST.
 For Navy, mail comments to the Commander, Naval Electronics Systems Command, ATTN. ELEX 45053 (O.H.), Washington, DC 20360.
 In either case, a reply will be furnished direct to you.

Table of Contents

SECTION		Page	Illus Figure
	I. Introduction	1	
	II. P-fit	5	
GROUP	00 Generator, Signal SG-1054/G	5	1
	01 Circuit Card Assembly, Selector Switch A14, 80372200-00	9	2
	0 2 Crystal Bracket Assembly A11, 90372006-000	11	3
	03 Power Supply, Pattern Generator A12, 90372004-000	13	4
	0 4 Circuit Card Assembly, Pattern Generator Harness A 10, 80372090 -000	15	5

*This manual supersedes so much of TM 11-6625-2921-14&P, 16 January 1980, as pertains to repair parts and special tools list.

		Page	Illus Figure		
G R O U P	05	Circuit Card Assembly, Time Base Logic A1, 80372010-000.....	1 7	6	
		0501 Circuit Card Assembly, Oscillator A1A1, 80372190-000.....	1 9	7	
	0 6	Circuit Card Assembly, Power Supply A2, 80372020-000.....	2 1	8	
	0 7	Circuit Card Assembly, Data Output Circuits Hi-Low Level A3 80372030-000.....	2 5	9	
	0 8	Circuit Card Assembly, Message Control Circuits A4, 80372040 -000.....	2 9	10	
	0 9	Circuit Card Assembly, Distortion Generator A5, 80372050-000.....	3 1	11	
	1 0	Circuit Card Assembly, Message Generator A6, 80372060-000.....	3 3	12	
	1 1	Circuit Card Assembly, Character Distribution and Timing Control A7, 80372070-000.....	3 5	13	
	1 2	Circuit Card Assembly, Signal Pattern Matrix A8, 80372080-000.....	3 7	14	
	1 3	Circuit Card Assembly, Extender A9, 80372180-000.....	3 9	15	
	S E C T I O N	III.	Special Tools List (Not applicable)		
		IV.	National Stock Number and Part Number Index	4 0	

SECTION I

INTRODUCTION

1. Scope

This manual lists spares and repair parts; special tools; special test, measurement, and diagnostic equipment (TMDE), and other special support equipment required for performance of organizational, direct support, and general support maintenance of the SG-1054/G. It authorizes the requisitioning and issue of spares and repair parts as indicated by the source and maintenance codes.

2. General

This Repair Parts and Special Tools List is divided into the following sections

a. Section II. Repair Parts List. A list of spares and repair parts authorized for use in the performance of maintenance. The list also includes parts which must be removed for replacement of the authorized parts. Parts lists are composed of functional groups in numeric sequence, with the parts in each group listed in figure and item number sequence.

b. Section III. Special Tools List. Not applicable.

c. Section IV. National Stock Number and Part Number Index. A list, in National item identification number (NIIN) sequence, of all National stock numbers (NSN) appearing in the listings, followed by a list, in alphameric sequence, of all part numbers appearing in the listings. National stock numbers and part numbers are cross-referenced to each illustration figure and item number appearance.

3. Explanation of Columns

a. Illustration This column is divided as follows:

(1) *Figure number.* Indicates the figure number of the illustration on which the item is shown.

(2) *Item number.* The number used to identify item called out in the illustration.

b. Source, Maintenance, and Recoverability (SMR) Codes.

(1) *Source code.* Source codes indicate the manner of acquiring support items for maintenance, repair, or overhaul of end items. Source codes are entered in the first and second positions of the Uniform SMR Code format as follows:

Code	Definition
-------------	-------------------

PA	Item procured and stocked for anticipated or known usage.
----	---

Code

Definition

- | | |
|----|---|
| PB | Item procured and stocked for insurance purpose because essentiality dictates that a minimum quantity be available in the supply system. |
| PD | Support item, excluding support equipment, procured for initial issue or outfitting and stocked only for subsequent or additional initial issues or outfitting. Not subject to automatic replenishment. |
| XA | Item is not procured or stocked because the requirements for the item will result in the replacement of the next higher assembly. |
| XB | Item is not procured or stocked. If not available through salvage, requisition. |
| XD | A support item that is not stocked. When required, item will be procured through normal supply channels. |

NOTE

Cannibalization or salvage may be used as a source of supply for any items source coded above except those coded XA and aircraft support items as restricted by AR 700-42.

(2) *Maintenance code.* Maintenance codes are assigned to indicate the levels of maintenance authorized to USE and REPAIR support items. The maintenance codes are entered in the third and fourth positions of the Uniform SMR Code format as follows:

(a) The maintenance code entered in the third position will indicate the lowest maintenance level authorized to remove, replace, and use the support item. The maintenance code entered in the third position will indicate one of the following levels of maintenance:

Code	Application/Explanation
-------------	--------------------------------

- | | |
|---|---|
| O | Support item is removed, replaced, used at the organizational level. |
| F | Support item is removed, replaced, used at the direct support level. |
| H | Support item is removed, replaced, used at the general support level. |

(b) The maintenance code entered in the fourth position indicates whether the item is to be repaired and identifies the lowest maintenance level with the capability to perform complete repair (i.e.,

all authorized maintenance functions). This position will contain one of the following maintenance codes:

Code	Application Explanation
D	The lowest maintenance level capable of complete repair of the support item is the depot level.
L	Repair restricted to designated specialized repair activity.
Z	Nonreparable. No repair is authorized.

(3) *Recoverability code.* Recoverability Codes are assigned to support items to indicate the disposition action on unserviceable items. The recoverability code is entered in the fifth position of the Uniform SMR Code format as follows:

Recoverability codes	Definition
Z	Nonreparable item. When unserviceable, condemn and dispose at the level indicated in position 3.
H	Reparable item. When uneconomically repairable, condemn and dispose at the general support level.
D	Reparable item. When beyond lower level repair capability, return to depot. Condemnation and disposal not authorized below depot level.
L	Reparable item. Repair, condemnation, and disposal not authorized below depot/ specialized repair activity level.

c. National Stock Number. Indicates the National stock number assigned to the item and will be used for requisitioning purposes.

d. Federal Supply Code for Manufacturer (FSCM). The FSCM is a 5-digit numeric code listed in SB 708-41/42 which is used to identify the manufacturer, distributor, or Government agency, etc.

e. Part Number. Indicates the primary number used by the manufacturer (individual, company, firm, corporation, or Government activity), which controls the design and characteristics of the item by means of its engineering drawings, specifications, standards, and inspection requirements to identify an item or range of items.

NOTE

When a stock numbered item is requisitioned, the repair part received may have a different put number than the part being replaced.

f. Description Indicates the Federal item name and, if required, a minimum description to identify the item.

g. Unit of Measure (U/M). Indicates the standard of the basic quantity of the listed item as used in performing the actual maintenance function. This measure is expressed by a two-character alphabetical abbreviation (e.g., ea. in, pr, etc). When

the unit of measure differs from the unit of issue, the lowest unit of issue that will satisfy the required unit of measure will be requisitioned.

h. Quantity Incorporated in Unit. Indicates the quantity of the item used in the breakout shown on the illustration figure, which is prepared for a fictional group, subfunctional group, or an assembly.

4. Special Information

a. The following publication pertains to the SG-1054/G and its components
TM 11-6625-2921-14&P, Signal Generator, SG-1054/G (Stelma Model PG-303A).

b. National stock numbers (NSN's) that are missing from P source coded items have been applied for and will be added to this TM by future Change/revision when they are entered in the Army Master Data File (AMDF). Until the NSN's are established and published, submit exception requisitions to: Commander, US Army Communications-Electronics Command and Fort Monmouth, ATTN: DRSEL-MM, Fort Monmouth, New Jersey 07703 for the part required to support your equipment.

5. How to Locate Repair Parts

a. When National stock number or part number is unknown.

(1) *First.* Using the table of contents, determine the functional group within which the item belongs. This is necessary illustrations are prepared for functional groups and listings are divided into the same groups.

(2) *Second* Find the illustration covering the functional group to which the item belongs.

(3) *Third* Identify the item on the illustration and note the illustration figure and item number of the item.

(4) *Fouth* Using the Repair Parts Listing, find the figure and item number noted on the illustration.

b. When National stock number or part number is known.

(1) *First.* Using the Index of National Stock Numbers and Part Numbers, find the pertinent National stock number or part number. This index is in NIIN sequence followed by a list of part numbers in alphameric sequence, croee.referenced to the illustration figure number and item number.

(2) *Second.* After finding the figure and item number, locate the figure and item number in the repair parts list.

6. Abbreviations

Not applicable.

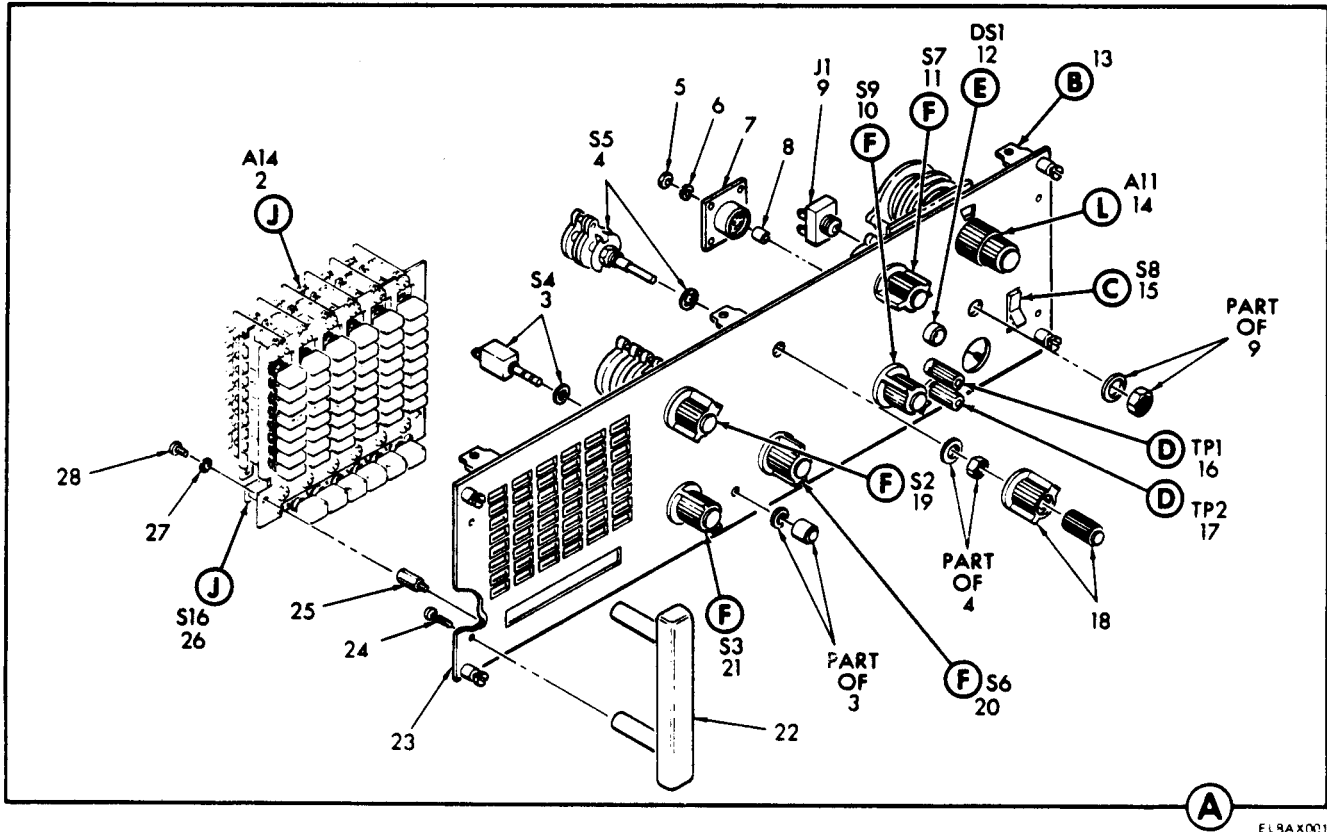
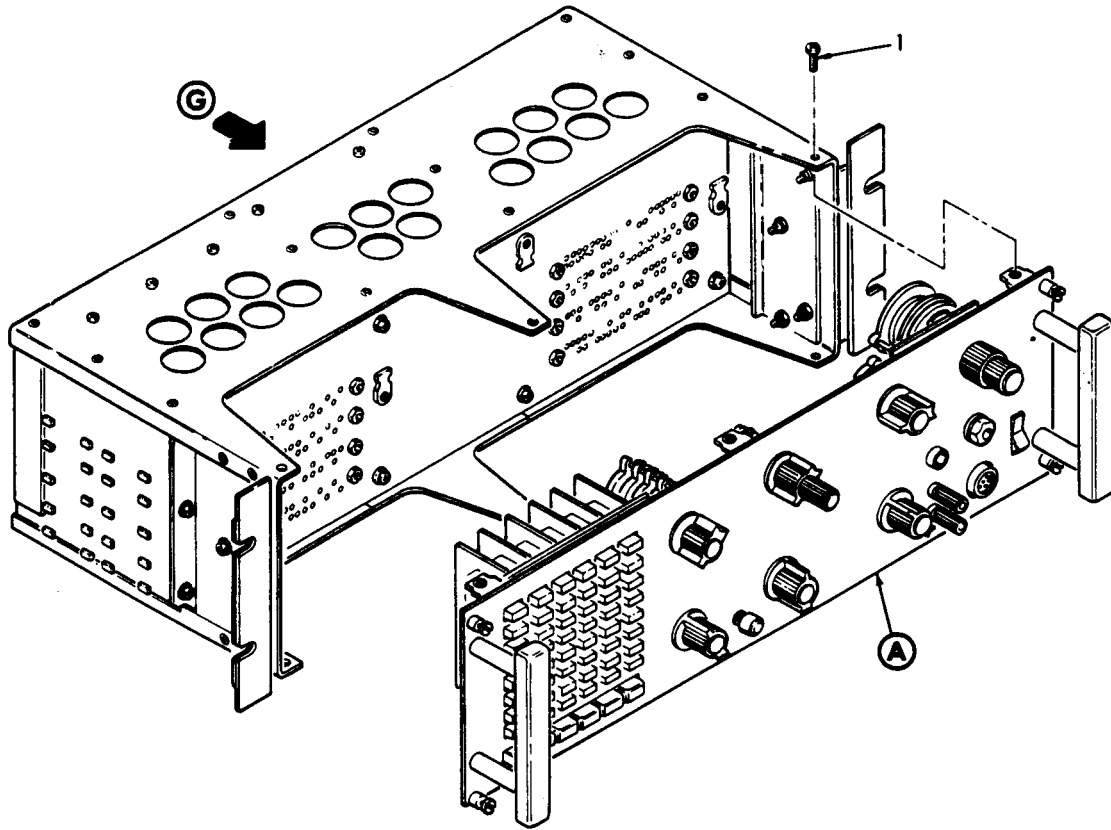

EL9A X001

Figure 1. Generator, Signal, SG-1054/G (Sheet 1 of 3)

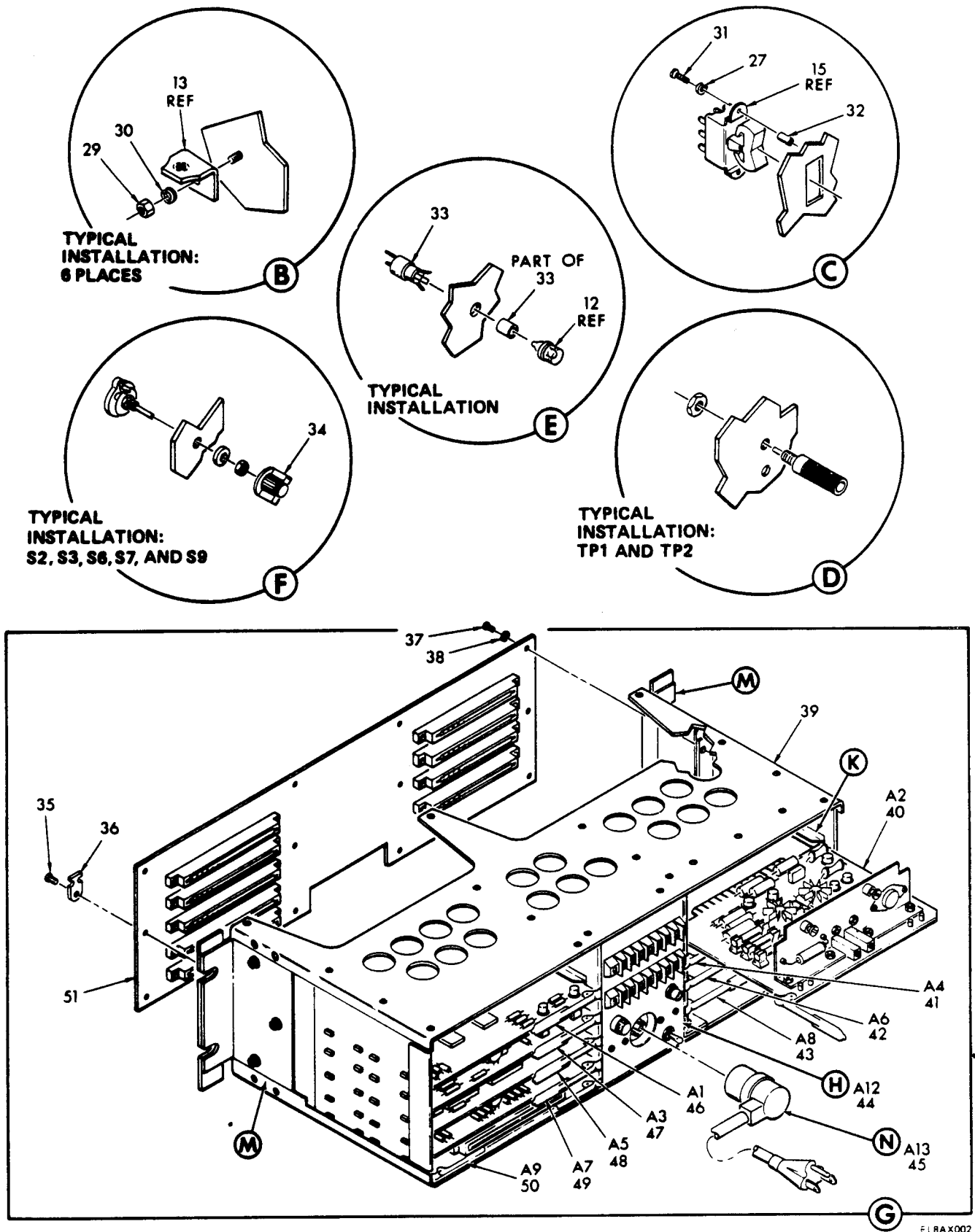

ELBA X002

Figure 1. Generator, Signal, SG-1054/G (Sheet 2 of 3)

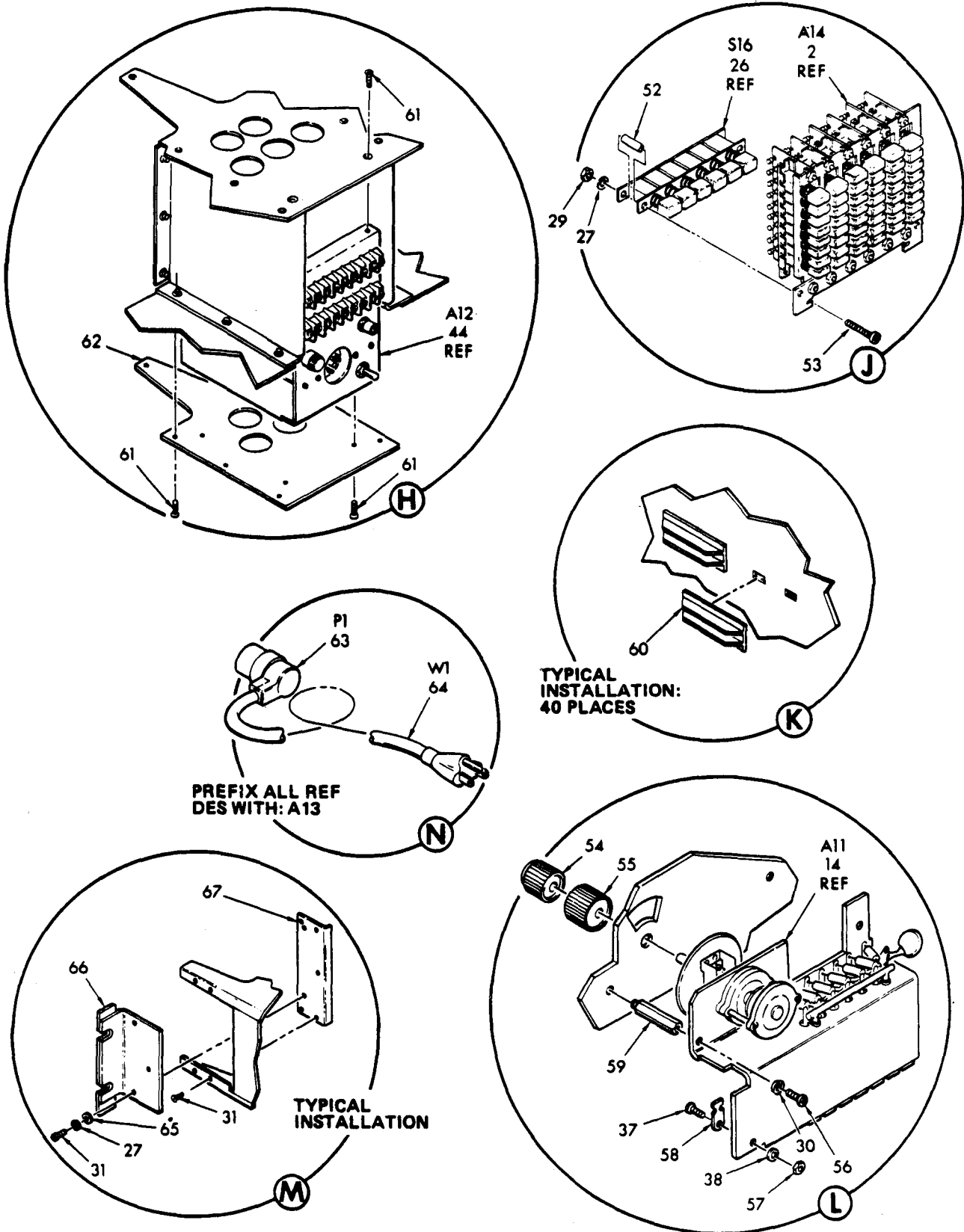

ELBA X003

Figure 1. Generator, Signal, SG-1054/G (Sheet 3 of 3)

SECTION II

(1)	(2)	(3)	(4)	(5)	(6)	(7)	(8)
ILLUSTRATION					DESCRIPTION		QTY
(a)	(b)	NATIONAL		PART			INC
FIG	ITEM	STOCK		NUMBER			IN
NO	NO	NUMBER	FSCM	NUMBER		USABLE ON CODE	U/M
							UNIT
GROUP 00 GENERATOR,SIGNAL,SG-1054/G							
1	1	PAHZZ 5305-00-770-2533	96906	MS51959-13	SCREW,MACHINE		EA 5
1	2	PAHDD 6625-00-209-5333	96238	80372200-000	CIRCUIT CARD ASSEMB A14		EA 1
1	3	PAHZZ 5930-00-059-3399	95146	MSP105F	SWITCH,PUSH		EA 1
1	4	PAHZZ 5930-01-013-7293	96238	46020391-000	SWITCH,ROTARY		EA 1
1	5	PAHZZ 5310-00-934-9748	96906	MS35649-244	NUT,PLAIN,HEXAGON		EA 2
1	6	PAHZZ 5310-00-933-8118	96906	MS35338-135	WASHER, LOCK		EA 2
1	7	PAHZZ 5935-01-009-5653	96238	90372005-000	CONNECTOR,RECEPTACL		EA 1
1	8	PAHZZ 5310-00-725-1893	83330	2121	NUT,PLAIN,ROUND		EA 2
1	9	PAHZZ 5935-00-893-3935	82389	N112A	JACK,TELEPHONE		EA 1
1	10	PAHZZ 5930-01-013-8410	96238	46020388-000	SWITCH,ROTARY		EA 1
1	11	PAHZZ 5930-01-009-7615	96238	46020383-000	SWITCH,ROTARY		EA 1
1	12	PAHZZ 6240-00-001-1524		507-3905-1437-50 72619 0	LAMP,CARTRIDGE		EA 1
1	13	XBHZZ	96238	62021579000D	BRACKET,ANGLE		EA 6
1	14	XBHHH	96238	90372006-000	CRYSTAL UNIT SET A14		EA 1
1	15	PAHZZ 5930-01-123-5287	22753	LR5W322N1250CRSS	SWITCH,ROCKER		EA 1
1	16	PAHZZ 5940-00-615-2282	74970	111-102	POST,BINDING,ELECTR		EA 1
1	17	PAHZZ 5940-00-688-2770	74970	111-103	POST,BINDING,ELECTR		EA 1
1	18	XBHZZ	96238	57025147-000	KNOB		EA 1
1	19	PAHZZ 5930-01-013-8411	96238	46020389-000	SWITCH,ROTARY		EA 1
1	20	PAHZZ 5930-01-013-7294	96238	46020397-000	SWITCH,ROTARY		EA 1
1	21	PAHZZ 5930-01-013-8409	96238	46020386-000	SWITCH,ROTARY		EA 1
1	22	XBHZZ	96238	56025087-000	HANDLE		EA 2
1	23	XBHZZ	96238	61010323000M	PANEL,FRONT		EA 1
1	24	PAHZZ 5305-00-763-6963	96906	MS51959-28	SCREW,MACHINE		EA 4
1	25	XBHZZ	96238	NO PART NO-4	POST,MECHANICAL		EA 2
1	26	PAHZZ 5930-01-010-7648	96238	46027640-000	SWITCH,PUSH		EA 1
1	27	PAHZZ 5310-00-933-8118	96906	MS35338-135	WASHER,LOCK		EA 4
1	28	PAHZZ 5305-00-054-5646	96906	MS51957-12	SCREW,MACHINE		EA 4
1	29	PAHZZ 5310-00-934-9761	96906	MS35649-264	NUT,PLAIN,HEXAGON		EA 6
1	30	PAHZZ 5310-00-929-6395	96906	MS35338-136	WASHER, LOCK		EA 6
1	31	PAHZZ 5305-00-054-5648	96906	MS51957-14	SCREW,MACHINE		EA 2
1	32	PAHZZ 5310-00-445-8845	83330	8766	NUT,PLAIN,ROUND		EA 2
1	33	PAHZZ	72619	515-0012	LAMPHOLDER		EA 1
1	34	XBHZZ	21604	PS70D95C2BLK	KNOB		EA 5
1	35	PAHZZ 5305-00-763-6962	96906	MS51959-27	SCREW,MACHINE		EA 3
1	36	XBHZZ	96238	NO PART NO-1	CLAMP,CABLE		EA 9
1	37	PAHZZ 5305-00-054-6651	96906	MS51957-27	SCREW,MACHINE		EA 9
1	38	PAHZZ 5310-00-722-5998	96906	MS15795-805	WASHER,FLAT		EA 9

SECTION II

(1)	(2)	(3)	(4)	(5)	(6)	(7)	(8)
ILLUSTRATION					DESCRIPTION		QTY
(a)	(b)	NATIONAL		PART			INC
FIG	ITEM	STOCK		NUMBER		USABLE ON CODE	IN
NO	NO	NUMBER	FSCM	NUMBER			UNIT
1	39	XAHZZ		96238	62070226012C		EA 1
1	40	PAHDD	6625-00-205-0298	96238	80372020-000		EA 1
1	41	PAHDH	6625-00-207-9851	96238	80372040-000		EA 1
1	42	PAHDD	6625-00-213-2624	96238	80372060-000		EA 1
1	43	PAFLD	6625-00-213-2620	96238	80372080-000		EA 1
1	44	PAHDH	6625-01-098-1367	96238	90372004-000		EA 1
1	45	PAOZZ		96238	74000054-000		EA 1
1	46	PAHDD	6625-00-205-0294	96238	80372010-000		EA 1
1	47	PAHDD	6625-00-205-0299	96238	80372030-000		EA 1
1	48	PAHDD	6625-00-207-9922	96238	80372050-000		EA 1
1	49	PAHDD	6625-00-207-9930	96238	80372070-000		EA 1
1	50	PAHDD	6625-00-213-2686	96238	80372180-000		EA 1
1	51	PAHDD	6625-00-213-2621	96238	80372090-000		EA 1
1	52	XBHZZ		57177	102-11AL091X		EA 2
1	53	PAHZZ	5305-00-400-8531	96906	MS51957-121		EA 2
1	54	XBHZZ		21604	PS70D95C2BLK		EA 1
1	55	XBHZZ		21604	PS70D95C1BLK		EA 1
1	56	PAHZZ	5305-00-054-6652	96906	MS51957-28		EA 2
1	57	PAHZZ	5310-00-934-9748	96906	MS35649-244		EA 1
1	58	XBHZZ		96238	NO PART NO-1		EA 1
1	59	XBHZZ		06540	8232-B-0440		EA 2
1	60	XBHZZ		96238	61100118-000		EA 40
1	61	PAHZZ	5305-00-763-7822	96906	MS51959-14		EA 2
1	62	XBHZZ		96238	62070229000B		EA 1
1	63	XAOZZ		74545	7571		EA 1
1	64	XAOZZ		96238	74000000-002		EA 1
1	65	PAHZZ	5310-00-595-6211	96906	MS15795-803		EA 3
1	66	XAHZZ		96238	62021577000D		EA 1
1	67	XBHZZ		96238	62021580000D		EA 2

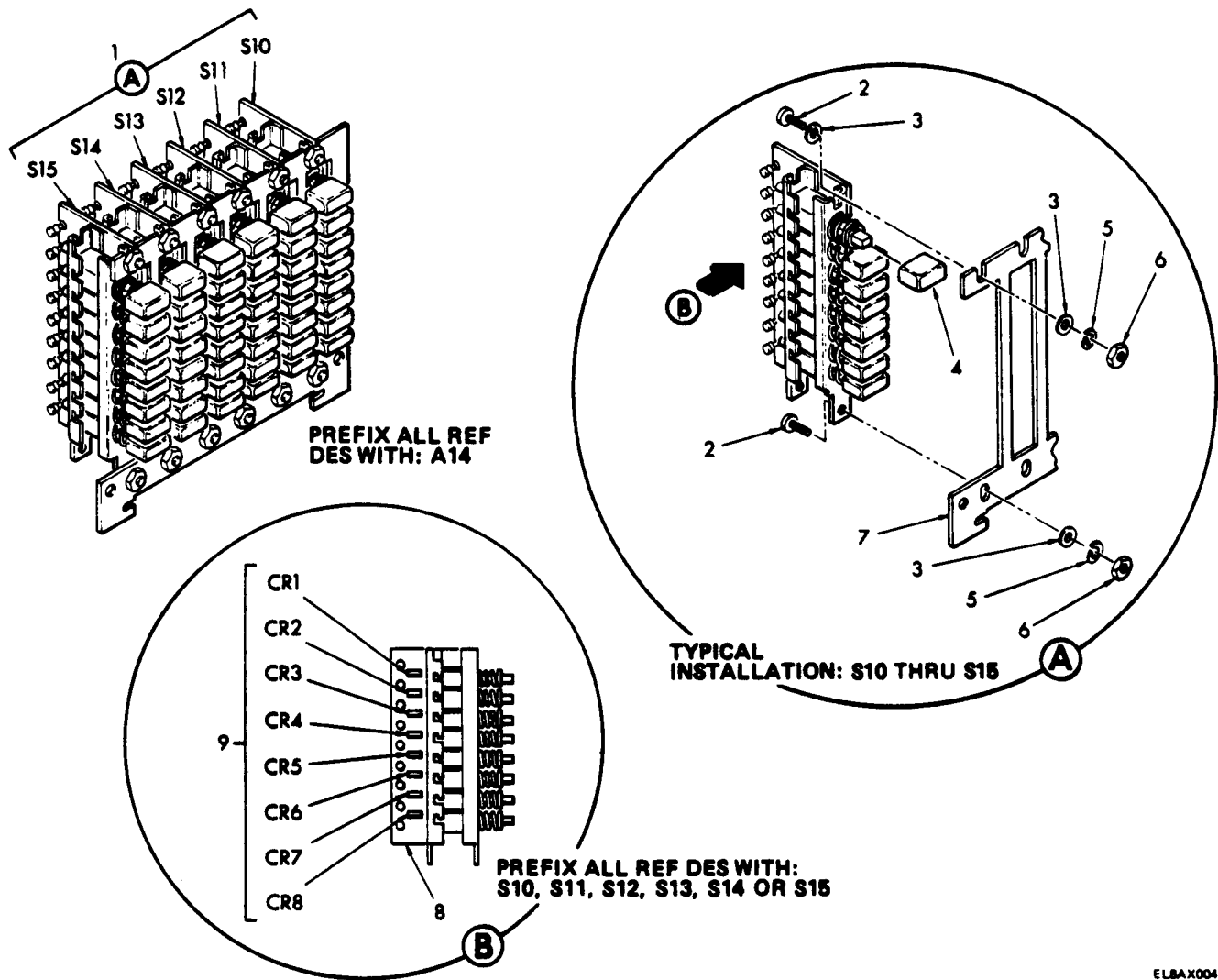

ELBAX004

Figure 2. Circuit card Assembly, Selector Switch (A 14), 80372200-000

SECTION II

(1)	(2)	(3)	(4)	(5)	(6)	(7)	(8)
ILLUSTRATION					DESCRIPTION		QTY
(a)	(b)	NATIONAL					INC
FIG	ITEM	SMR	STOCK	PART			IN
NO	NO	CODE	NUMBER	FSCM	NUMBER	USABLE ON CODE	U/M
							UNIT
GROUP 01 CIRCUIT CARD ASSY,SELECTOR,							
SWITCH (A14),80372200-000							
2	1	PAHZZ	5930-01-098-7058	96238	46027662-000	SWITCH,PUSH	EA 6
2	2	PAHZZ	5305-00-054-5648	96906	MS51957-14	SCREW,MACHINE	EA 12
2	3	PAHZZ	5310-00-595-6211	96906	MS15795-803	WASHER,FLAT	EA 24
2	4	XBHZZ		82104	400-3	PUSH BUTTON	EA 40
2	5	PAHZZ	5310-00-933-8118	96906	MS35338-135	WASHER,LOCK	EA 24
2	6	PAHZZ	5310-00-934-9748	96906	MS35649-244	NUT,PLAIN,HEXAGON	EA 12
2	7	XBHZZ		96238	NO PART NO-5	BRACKET,SWITCH MTG	EA 1
2	8	XAHZZ		96238	80372202B	PRINTED WIRING BD	EA 6
2	9	PAHZZ	5961-00-842-9864	81349	JAN1N914	SEMICONDUCTOR DEVIC	EA 8

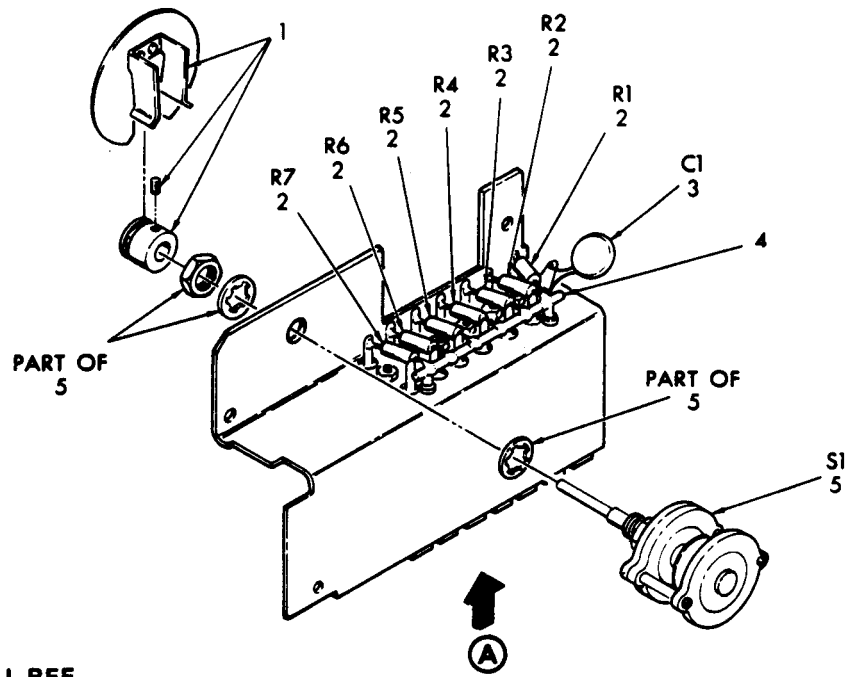

**PREFIX ALL REF
DES WITH: A11**

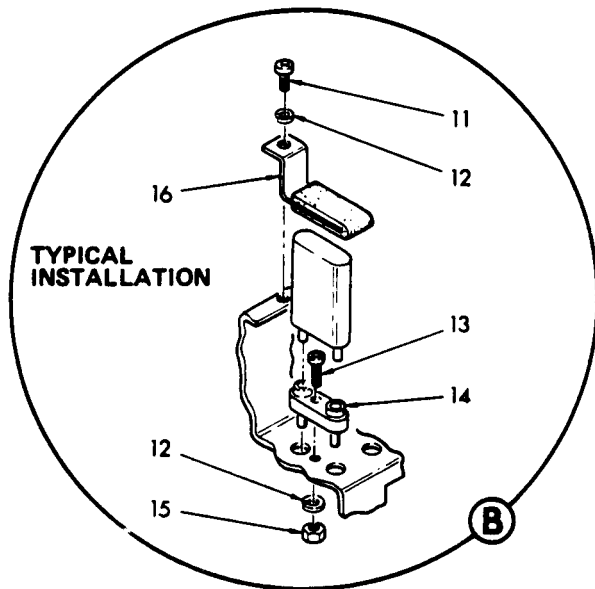
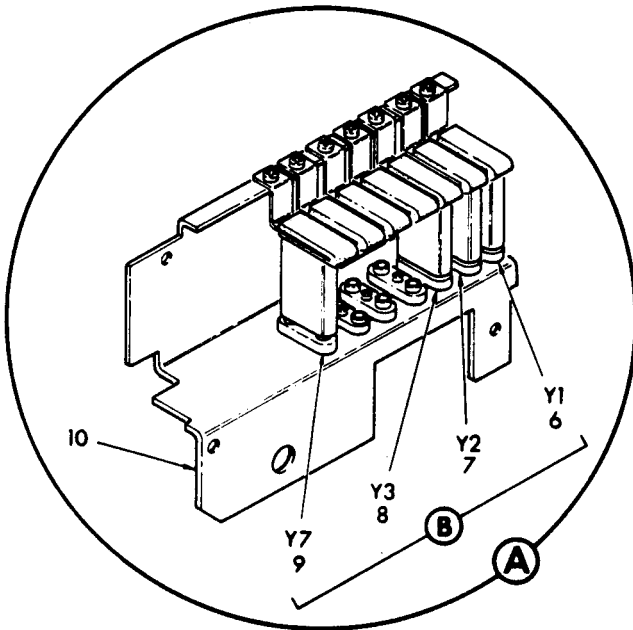

EL8AX005

Figure 3. Crystal Bracket Assembly (A 11), 90372006-000

SECTION II

(1)	(2)	(3)	(4)	(5)	(6)	(7)	(8)
ILLUSTRATION					DESCRIPTION		QTY
(a)	(b)	NATIONAL		PART			INC
FIG	ITEM	SMR	STOCK	FSCM		USABLE ON CODE	IN
NO	NO	CODE	NUMBER	NUMBER			UNIT
GROUP 02 CRYSTAL BRACKET ASSY, (ALL)							
90372006-000							
3	1	XBHZZ		96238	57000020-000		EA 1
3	2	PAHZZ	5905-00-110-7620	81349	RCR07G102JS		EA 7
3	3	XDHZZ	5910-00-241-1424	56289	5GAS15		EA 1
3	4	XBHZZ		96238	NO PART NO-6		EA 1
3	5	PAHZZ	5930-01-115-4083	71450	C212-26036-2-1		EA 1
3	6	PAHZZ	5955-00-233-7288	96238	40040082-001		EA 1
3	7	PAHZZ	5955-01-009-4538	96238	40040082-004		EA 1
3	8	PAHZZ	5955-00-233-7287	96238	40040082-003		EA 1
3	9	PAHZZ	5955-00-146-3855	96238	40040081-000		EA 1
3	10	XBHZZ		96238	62030755000A		EA 1
3	11	PAHZZ	5305-00-054-5648	96906	MS51957-14		EA 7
3	12	PAHZZ	5310-00-933-8118	96906	MS35338-135		EA 7
3	13	PAHZZ	5305-00-054-5651	96906	MS51957-17		EA 7
3	14	PAHZZ	5935-00-581-6941	81349	TS0205P01		EA 7
3	15	PAHZZ	5310-00-934-9748	96906	MS35649-244		EA 7
3	16	XBHZZ		96238	NO PART NO-2		EA 7

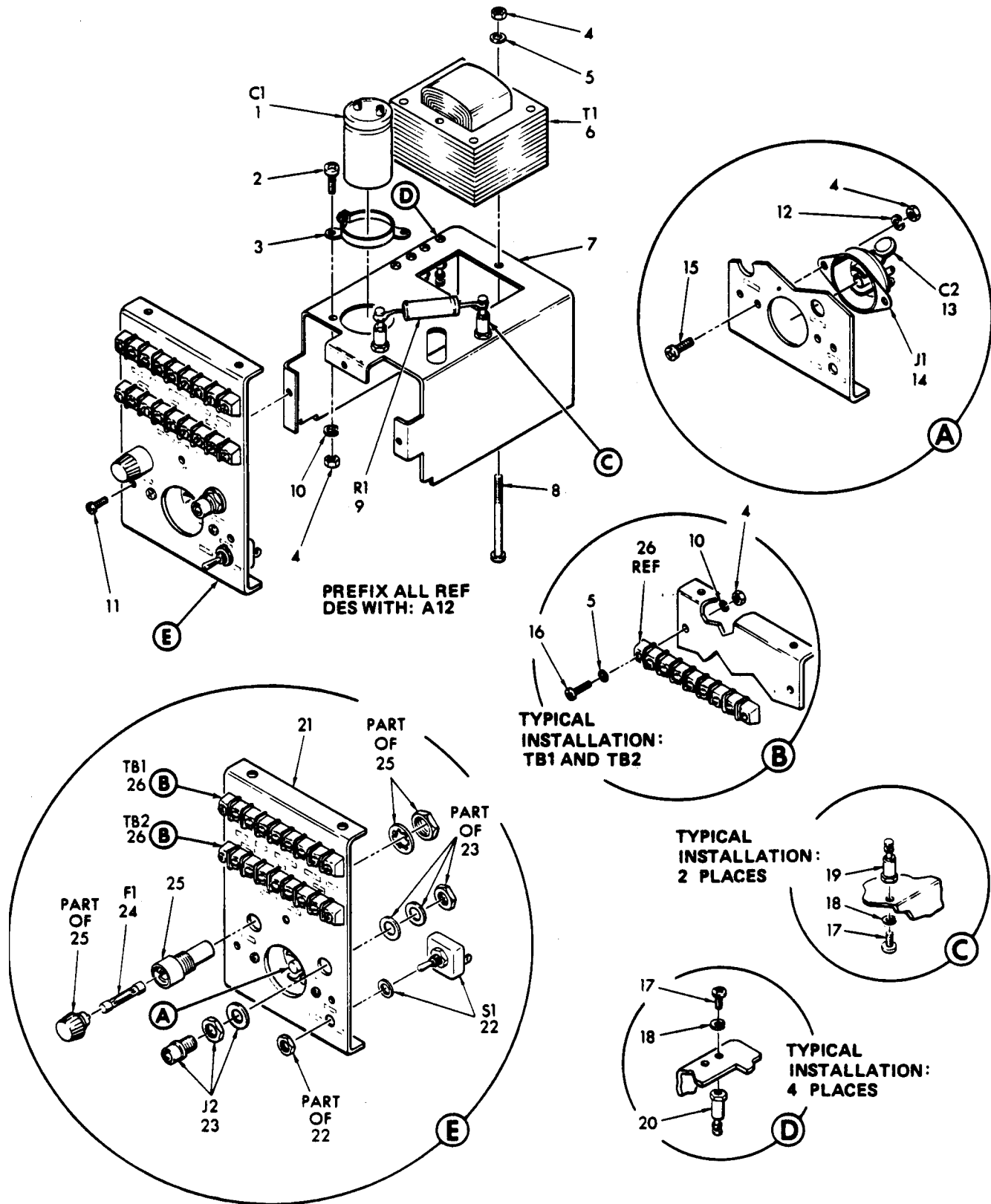

EL8AX006

Figure 4. Power Supply, Pattern Generator (A 12), 90372004-000

SECTION II

(1) ILLUSTRATION (a) FIG NO	(2) (b) ITEM NO	(3) NATIONAL STOCK NUMBER	(4) FSCM	(5) PART NUMBER	(6) DESCRIPTION	(7) USABLE ON CODE	(8) QTY INC IN UNIT
GROUP 03 POWER SUPPLY,PATTERN GENERATOR							
(A12),90372004-000							
4	1	PAHZZ 5910-00-828-7905	56289	36D462G015AA2A	CAPACITOR, FIXED, ELE		EA 1
4	2	PAHZZ 5305-00-054-6652	96906	MS51957-28	SCREW, MACHINE		EA 2
4	3	XBHZZ	96238	NO PART NO-3	RETAINER, CAPACITOR		EA 1
4	4	PAHZZ 5310-00-934-9761	96906	MS35649-264	NUT, PLAIN, HEXAGON		EA 2
4	5	PAHZZ 5310-00-722-5998	96906	MS15795-805	WASHER, FLAT		EA 2
4	6	PAHZZ 5950-01-046-6968	96238	43000276-000	TRANSFORMER, POWER		EA 1
4	7	XAHZZ	96238	62000436000K	CHASSIS, MOUNTING		EA 1
4	8	PAHZZ 5305-00-054-6661	96906	MS51957-37	SCREW, MACHINE		EA 2
4	9	PAHZZ 5905-00-975-1139	81349	RW67V332	RESISTOR, FIXED, WIRE		EA 1
4	10	PAHZZ 5310-00-929-6395	96906	MS35338-136	WASHER, LOCK		EA 2
4	11	PAHZZ 5305-00-054-6652	96906	MS51957-28	SCREW, MACHINE		EA 3
4	12	PAHZZ 5310-00-929-6395	96906	MS35338-136	WASHER, LOCK		EA 2
4	13	PAHZZ 5910-00-109-1987	81349	CK63AY103M	CAPACITOR, FIXED, CER		EA 2
4	14	PAHZZ 5935-00-937-4219	74545	7595	CONNECTOR, RECEPTACL		EA 1
4	15	PAHZZ 5305-00-054-6650	96906	MS51957-26	SCREW, MACHINE		EA 2
4	16	PAHZZ 5305-00-411-0683	96906	MS51957-123	SCREW, MACHINE		EA 4
4	17	PAHZZ 5305-00-054-5637	96906	MS51957-3	SCREW, MACHINE		EA 2
4	18	PAHZZ 5310-00-934-0226	96906	MS35338-153	WASHER, LOCK		EA 2
4	19	PAHZZ 5940-00-901-4899	71279	4821-1-0516	TERMINAL, STUD		EA 2
4	20	PAHZZ 5940-00-082-4814	81349	SE206D02	TERMINAL, STUD		EA 4
4	21	XBHZZ	96238	62030666000U	PLATE, MOUNTING		EA 1
4	22	XDHZZ 5930-00-902-2395	95146	MST105D	SWITCH, TOGGLE		EA 1
4	23	PAHZZ 5935-00-665-5718	80058	UG-1094/U	CONNECTOR, RECEPTACL		EA 1
4	24	PAHZZ 5920-00-043-2641	81349	F02A250V1-4A	FUSE, CARTRIDGE		EA 1
4	25	PAHZZ 5920-00-892-9311	81349	FHN26G1	FUSEHOLDER, EXTRACTO		EA 1
4	26	PAHZZ 5940-00-229-6900	75382	599-2004-7	TERMINAL BOARD		EA 2

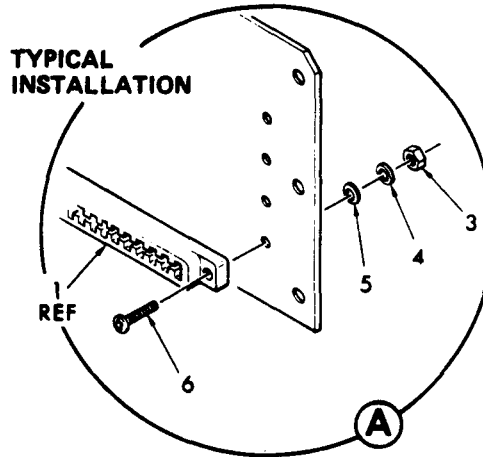
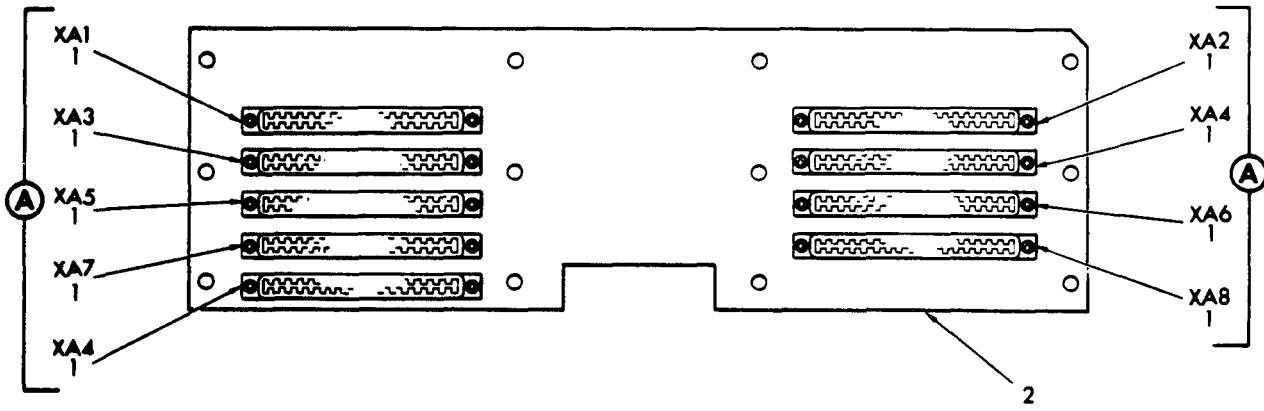

**PREFIX ALL REF
DES WITH: A10**

EL8AX007

Figure 5. Circuit Card Assembly, Pattern Generator Harness (A10), 80372090-000

SECTION II

(1)	(2)	(3)	(4)	(5)	(6)	(7)	(8)
ILLUSTRATION					DESCRIPTION		QTY
(a)	(b)	NATIONAL					INC
FIG	ITEM	SMR	STOCK	PART			IN
NO	NO	CODE	NUMBER	FSCM	NUMBER	USABLE ON CODE	U/M
							UNIT
GROUP 04 CIRCUIT CARD ASSY,PATTERN GENERAT							
OR HARNESS (A10),80372090-000							
5	1	PAHZZ	5935-00-563-1173	81349	M21097/21-145	CONNECTOR,RECEPTACL	EA 9
5	2	XAHZZ		96238	80370292E	PRINTED WIRING BD	EA 1
5	3	PAHZZ	5310-00-934-9748	96906	MS35649-244	NUT,PLAIN,HEXAGON	EA 18
5	4	PAHZZ	5310-00-933-8118	96906	MS35338-135	WASHER,LOCK	EA 18
5	5	PAHZZ	5310-00-595-6211	96906	MS15795-803	WASHER,FLAT	EA 18
5	6	PAHZZ	5305-00-054-5651	96906	MS51957-17	SCREW,MACHINE	EA 18

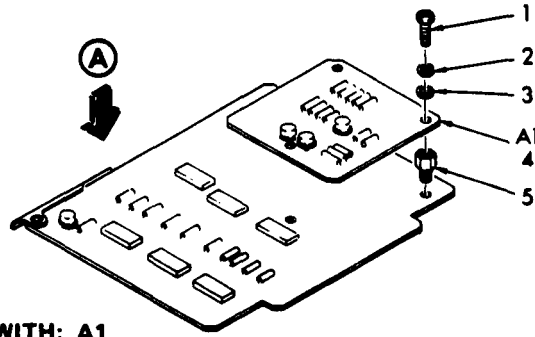

PREFIX ALL REF DES WITH: A1

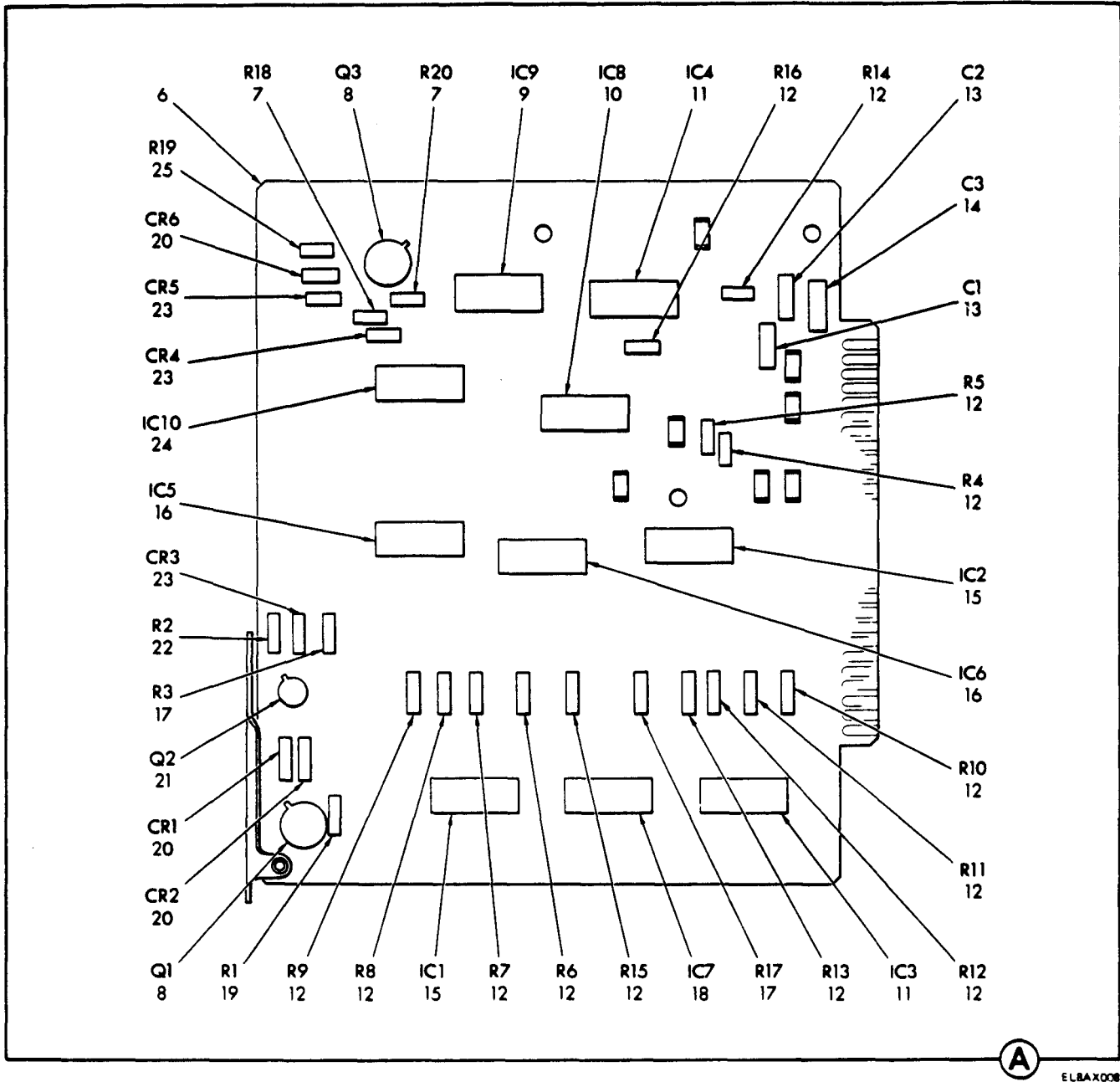

ELBAX008

Figure 6. Circuit Card Assembly, Time Base Logic (A1), 80372010-000

SECTION II		(2)	(3)	(4)	(5)	(6)	(7)	(8)
(1)	ILLUSTRATION		NATIONAL		PART	DESCRIPTION		QTY
FIG	ITEM	SMR	STOCK	FSCM	NUMBER		USABLE ON CODE	INC
NO	NO	CODE	NUMBER					IN
								UNIT
GROUP 05 CIRCUIT CARD ASSY, TIME BASE LOGIC								
(A1) 80372010-000								
6	1	PAHZZ	5305-00-054-5647	96906	MS51957-13	SCREW, MACHINE		EA 3
6	2	PAHZZ	5310-00-933-8118	96906	MS35338-135	WASHER, LOCK		EA 3
6	3	PAHZZ	5310-00-595-6211	96906	MS15795-803	WASHER, FLAT		EA 3
6	4	XAHDD		96238	80372190-000	CIRCUIT CARD ASSEMB A1A1		EA 1
6	5	PAHZZ	5310-00-963-9950	83330	2332	NUT, PLAIN, HEXAGON		EA 3
6	6	XAHZZ		96238	80372012E	PRINTED WIRING BD		EA 1
6	7	PAHZZ	5905-00-131-9729	81349	RCR07G302JS	RESISTOR, FIXED, COMP		EA 2
6	8	PAHZZ	5961-00-951-8757	81349	JAN2N2222A	TRANSISTOR		EA 2
6	9	PAHZZ	5962-00-163-4166	01295	SN158094N	MICROCIRCUIT, DIGITA		EA 1
6	10	PAHZZ	5962-00-420-6545	01295	SN158099N	MICROCIRCUIT, DIGITA		EA 1
6	11	PAHZZ	5962-00-184-8205	04713	MC858P	MICROCIRCUIT, DIGITA		EA 2
6	12	PAHZZ	5905-00-106-3666	81349	RCR07G103JS	RESISTOR, FIXED, COMP		EA 13
6	13	PAHZZ		91418	TA01UFPORM35PCT	CAPACITOR, FIXED, CE		EA 2
6	14	PAHZZ	5910-00-236-8740	81349	M39003/01-2974	CAPACITOR, FIXED, ELE		EA 1
6	15	XDHZZ	5962-00-130-0353	01295	SN15849N	MICROCIRCUIT, DIGITA		EA 2
6	16	PAHZZ	5962-00-819-2215	01295	SNL5846N	MICROCIRCUIT, DIGITA		EA 2
6	17	PAHZZ	5905-00-110-7620	81349	RCR07G102JS	RESISTOR, FIXED, COMP		EA 2
6	18	PAHZZ	5962-00-405-8465	01295	SN159097J	MICROCIRCUIT, DIGITA		EA 1
6	19	PAHZZ	5905-00-110-7622	81349	RCR07G682JS	RESISTOR, FIXED, COMP		EA 1
6	20	PAHZZ	5961-00-842-9864	81349	JAN1N914	SEMICONDUCTOR DEVIC		EA 3
6	21	PAHZZ	5961-00-842-6937	81349	JAN2N706	TRANSISTOR		EA 1
6	22	PAHZZ	5905-00-105-7764	81349	RCR07G222JS	RESISTOR, FIXED, COMP		EA 1
6	23	PAHZZ	5961-00-669-6884	81349	JAN1N277	SEMICONDUCTOR DEVIC		EA 3
6	24	XDHZZ	5962-00-365-5728	81349	M38510/01302BCB	MICROCIRCUIT, DIGITA		EA 1
6	25	PAHZZ	5905-00-141-0717	81349	RCR07G473JS	RESISTOR, FIXED, COMP		EA 1

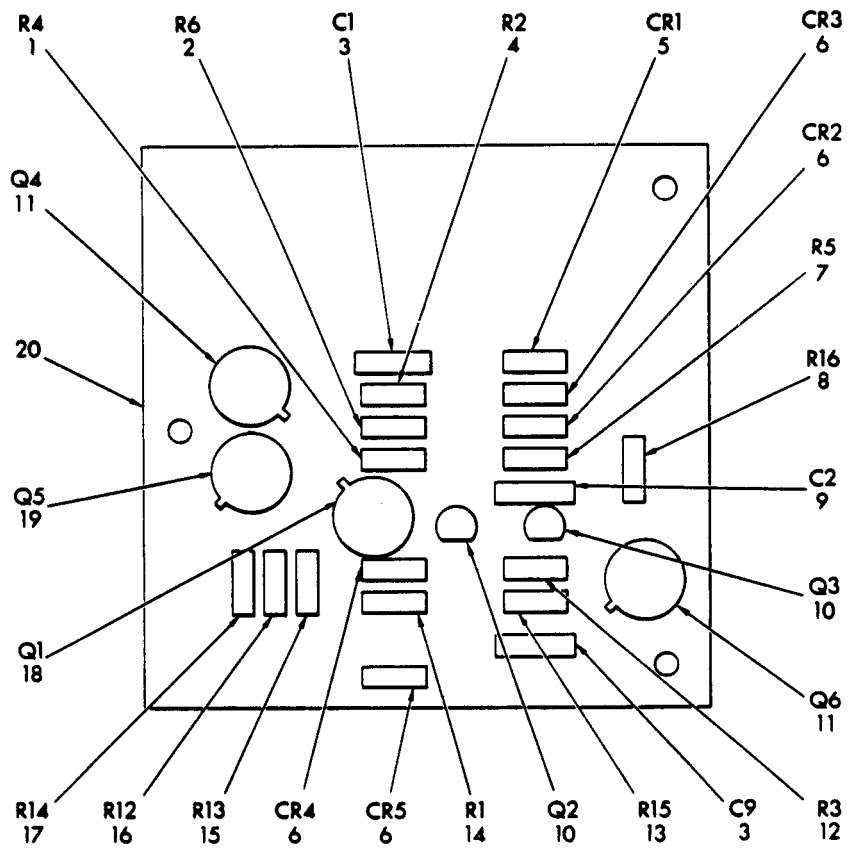

PREFIX ALL REF DES WITH: A1A1

ELBA XCG

Figure 7. Circuit Card Assembly, Oscillator (A1 A1), 80372190-000

SECTION II		(2)	(3)	(4)	(5)	(6)	(7)	(8)
(1)	ILLUSTRATION		NATIONAL			DESCRIPTION		QTY
(a)	(b)		STOCK		PART			INC
FIG	ITEM	SMR	NUMBER	FSCM	NUMBER		USABLE ON CODE	IN
NO	NO	CODE						UNIT
						GROUP 0501 CIRCUIT CARD ASSY, OSCILLATOR,		
						(A1A1), 80372190-000		
7	1	PAHZZ	5905-00-126-6683	81349	RCR07G332JS	RESISTOR, FIXED, COMP		EA 1
7	2	PAHZZ	5905-00-115-3560	81349	RCR07G183JS	RESISTOR, FIXED, COMP		EA 1
7	3	PAHZZ		91418	TA01UFPORM35PCT	CAPACITOR, FIXED, CE		EA 2
7	4	PAHZZ	5905-00-131-9729	81349	RCR07G302JS	RESISTOR, FIXED, COMP		EA 1
7	5	PAHZZ	5961-00-842-9864	81349	JAN1N914	SEMICONDUCTOR DEVIC		EA 1
7	6	PAHZZ		81349	JAN1N227	SEMICONDUCTOR DEVIC		EA 4
7	7	PAHZZ	5905-00-115-8055	81349	RCR07G393JS	RESISTOR, FIXED, COMP		EA 1
7	8	PAHZZ	5905-00-114-0708	81349	RCR07G202JS	RESISTOR, FIXED, FILM		EA 1
7	9	PAHZZ	5910-00-689-8751	94990	21-24425J01	CAPACITOR, FIXED, CER		EA 1
7	10	PAHZZ	5961-00-188-4279	80131	2N5222	TRANSISTOR		EA 2
7	11	PAHZZ	5961-00-842-6937	81349	JAN2N706	TRANSISTOR		EA 2
7	12	PAHZZ	5905-00-111-1679	81349	RCR07G512JS	RESISTOR, FIXED, COMP		EA 1
7	13	PAHZZ	5905-00-106-3666	81349	RCR07G103JS	RESISTOR, FIXED, COMP		EA 1
7	14	PAHZZ	5905-00-104-8358	81349	RCR07G822JS	RESISTOR, FIXED, COMP		EA 1
7	15	PAHZZ	5905-00-136-8406	81349	RCR07G242JS	RESISTOR, FIXED, COMP		EA 1
7	16	PAHZZ	5905-00-116-8555	81349	RCR07G153JS	RESISTOR, FIXED, COMP		EA 1
7	17	PAHZZ	5905-00-141-1183	81349	RCR07G101JS	RESISTOR, FIXED, COMP		EA 1
7	18	PAHZZ	5961-00-925-3777	81349	JAN2N2907A	TRANSISTOR		EA 1
7	19	PAHZZ	5961-00-951-8757	81349	JAN2N2222A	TRANSISTOR		EA 1
7	20	XAHZZ		96238	80372192D	PRINTED WIRING BD		EA 1

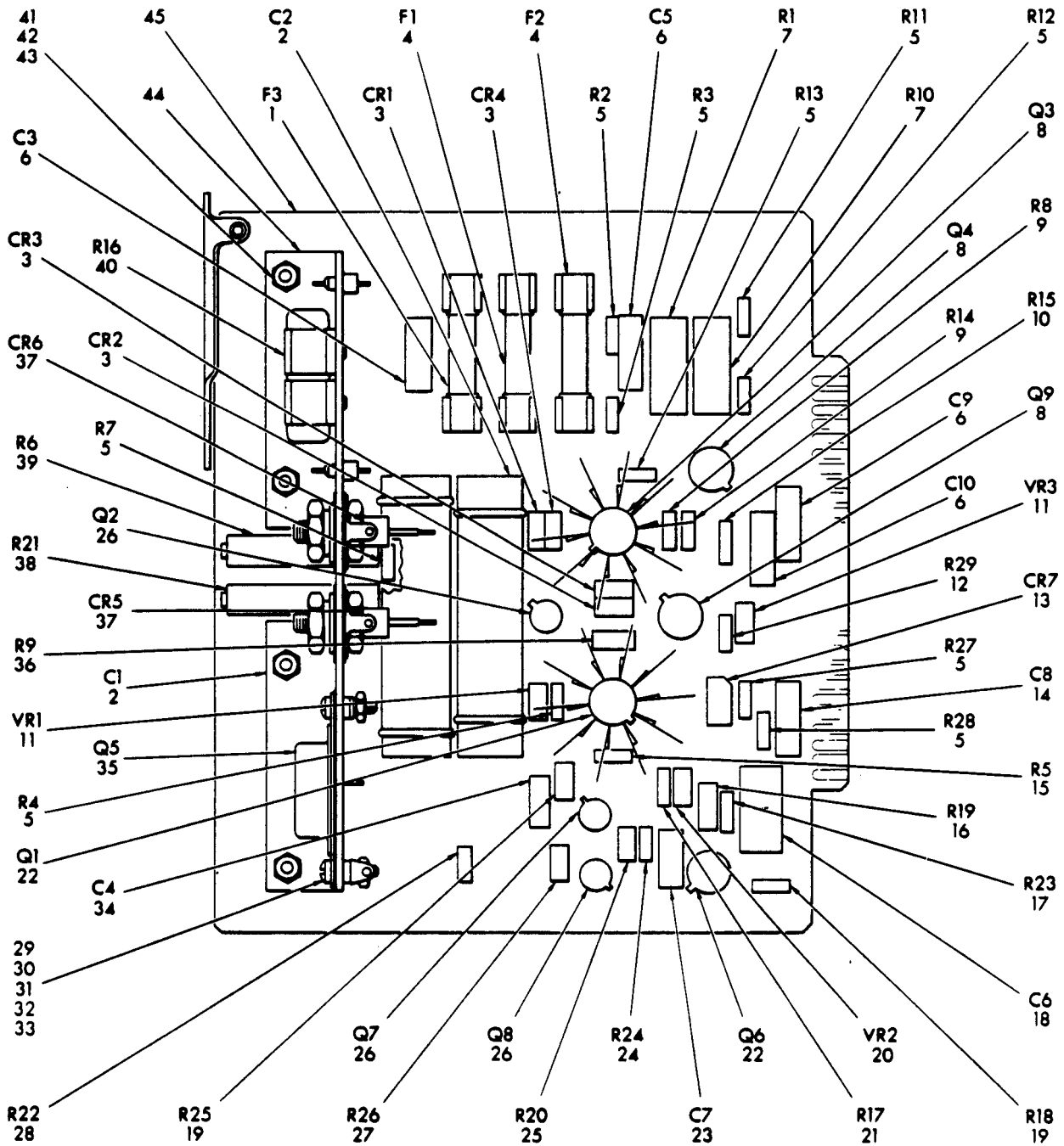

PREFIX ALL REF DES WITH: A2

ELBA X010

Figure 8. Circuit Card Assembly, Power Supply (A2), 80372020-000

SECTION II		(2)	(3)	(4)	(5)	(6)	(7)	(8)
(1)	ILLUSTRATION		NATIONAL		PART	DESCRIPTION		QTY
FIG	(a) (b)	SMR	STOCK	FSCM	NUMBER		USABLE ON CODE	INC
NO	NO	CODE	NUMBER					IN
								UNIT
						GROUP 06 CIRCUIT CARD ASSY,POWER SUPPLY,		
						(A2),80372020-000		
8	1	PAHZZ	5920-00-284-9494	81349	F02A250V3-4AS	FUSE,CARTRIDGE		EA 1
8	2	PAHZZ	5910-00-927-5130	56289	39D257G030EL4	CAPACITOR, FIXED, ELE		EA 2
8	3	PAHZZ	5961-00-087-6047	81349	JAN1N645	SEMICONDUCTOR DEVIC		EA 4
8	4	PAHZZ	5920-00-284-9493	81349	F02A250V1-8AS	FUSE,CARTRIDGE		EA 2
8	5	PAHZZ	5905-00-110-7620	81349	RCR07G102JS	RESISTOR, FIXED, COMP		EA 9
8	6	PAHZZ		81349	CSR13F156KM	CAPACITOR, FIXED, ELE		EA 4
8	7	PAHZZ	5905-00-156-0435	81349	RCR42G390JS	RESISTOR, FIXED, COMP		EA 2
8	8	PAHZZ	5961-00-949-1440	81349	JAN2N2905A	TRANSISTOR		EA 3
8	9	PAHZZ	5905-00-110-7622	81349	RCR07G682JS	RESISTOR, FIXED, COMP		EA 2
8	10	PAHZZ	5905-00-110-7620	81349	RCR07G102JS	RESISTOR, FIXED, COMP		EA 1
8	11	PAHZZ	5961-00-995-2310	81349	JAN1N752A	SEMICONDUCTOR DEVIC		EA 2
8	12	PAHZZ	5905-00-135-6046	81349	RCR07G681JS	RESISTOR, FIXED, COMP		EA 1
8	13	PAHZZ	5961-01-058-2331	03508	C106Q21	SEMICONDUCTOR DEVIC		EA 1
8	14	PAHZZ	5910-00-144-4383	81349	M39003/01-3026	CAPACITOR, FIXED, ELE		EA 1
8	15	PAHZZ	5905-00-106-1356	81349	RCR07G152JS	RESISTOR, FIXED, COMP		EA 1
8	16	PAHZZ	5905-00-114-5388	81349	RCR20G220JS	RESISTOR, FIXED, COMP		EA 1
8	17	PAHZZ	5905-00-105-7764	81349	RCR07G222JS	RESISTOR, FIXED, COMP		EA 1
8	18	PAHZZ	5910-01-030-9211	81349	CMR06F472GODR	CAPACITOR, FIXED, MIC		EA 1
8	19	PAHZZ	5905-00-105-7768	81349	RCR07G561JS	RESISTOR, FIXED, COMP		EA 2
8	20	PAHZZ	5961-00-847-5247	81349	JAN1N748A	SEMICONDUCTOR DEVIC		EA 1
8	21	PAHZZ	5905-00-141-0742	81349	RCR07G181JS	RESISTOR, FIXED, COMP		EA 1
8	22	PAHZZ	5961-00-813-9360	81349	JAN2N1613	TRANSISTOR		EA 2
8	23	PAHZZ	5910-01-052-8905	81349	CMR06F561GODR	CAPACITOR, FIXED, MIC		EA 1
8	24	PAHZZ	5905-00-120-9154	81349	RCR07G471JS	RESISTOR, FIXED, COMP		EA 1
8	25	PAHZZ	5905-00-308-6636	81349	RNC55K4530FS	RESISTOR, FIXED, FILM		EA 1
8	26	PAHZZ	5961-00-226-8579	81349	JAN2N930	TRANSISTOR		EA 3
8	27	PAHZZ	5905-00-136-3891	81349	RCR07G621JS	RESISTOR, FIXED, COMP		EA 1
8	28	PAHZZ	5905-00-233-9202	81349	RNC55K7320FS	RESISTOR, FIXED, FILM		EA 1
8	29	PAHZZ	5310-00-934-9748	96906	MS35649-244	NUT, PLAIN, HEXAGON		EA 2
8	30	PAHZZ	5310-00-933-8118	96906	MS35338-135	WASHER, LOCK		EA 2
8	31	PAHZZ	5310-00-595-6211	96906	MS15795-803	WASHER, FLAT		EA 2
8	32	PAHZZ	5310-00-058-3599	96906	MS35335-57	WASHER, LOCK		EA 1
8	33	PAHZZ	5305-00-054-5649	96906	MS51957-15	SCREW, MACHINE		EA 2
8	34	PAHZZ	5910-00-495-0042	81349	CSR13G105KS	CAPACITOR, FIXED, ELE		EA 1
8	35	PAHZZ	5961-00-752-6136	81349	JAN2N1011	TRANSISTOR		EA 1
8	36	PAHZZ	5905-00-111-8357	81349	RCR20G681JS	RESISTOR, FIXED, COMP		EA 1
8	37	PAHZZ	5961-00-978-5966	81349	JAN1N1614	SEMICONDUCTOR DEVIC		EA 2
8	38	PAHZZ	5905-01-067-4616	81349	RT12C2V201	RESISTOR, VARIABLE, W		EA 1

SECTION II

(1)	(2)	(3)	(4)	(5)	(6)	(7)	(8)
ILLUSTRATION					DESCRIPTION		QTY
(a)	(b)	NATIONAL		PART			INC
FIG	ITEM	SMR	STOCK	NUMBER		USABLE ON CODE	IN
NO	NO	CODE	NUMBER	FSCM	NUMBER		UNIT
8	39	PAHZZ	5905-00-682-4142	80294	200P1-501		EA 1
8	40	PAHZZ	5905-00-081-7348	81349	RW67V1R0		EA 1
8	41	PAHZZ	5310-00-934-9748	96906	MS35649-244		EA 4
8	42	PAHZZ	5310-00-595-6211	96906	MS15795-803		EA 4
8	43	PAHZZ	5305-00-054-5649	96906	MS51957-15		EA 4
8	44	XBHZZ		96238	62021578000G		EA 1
8	45	XAHZZ		96238	80372022E		EA 1

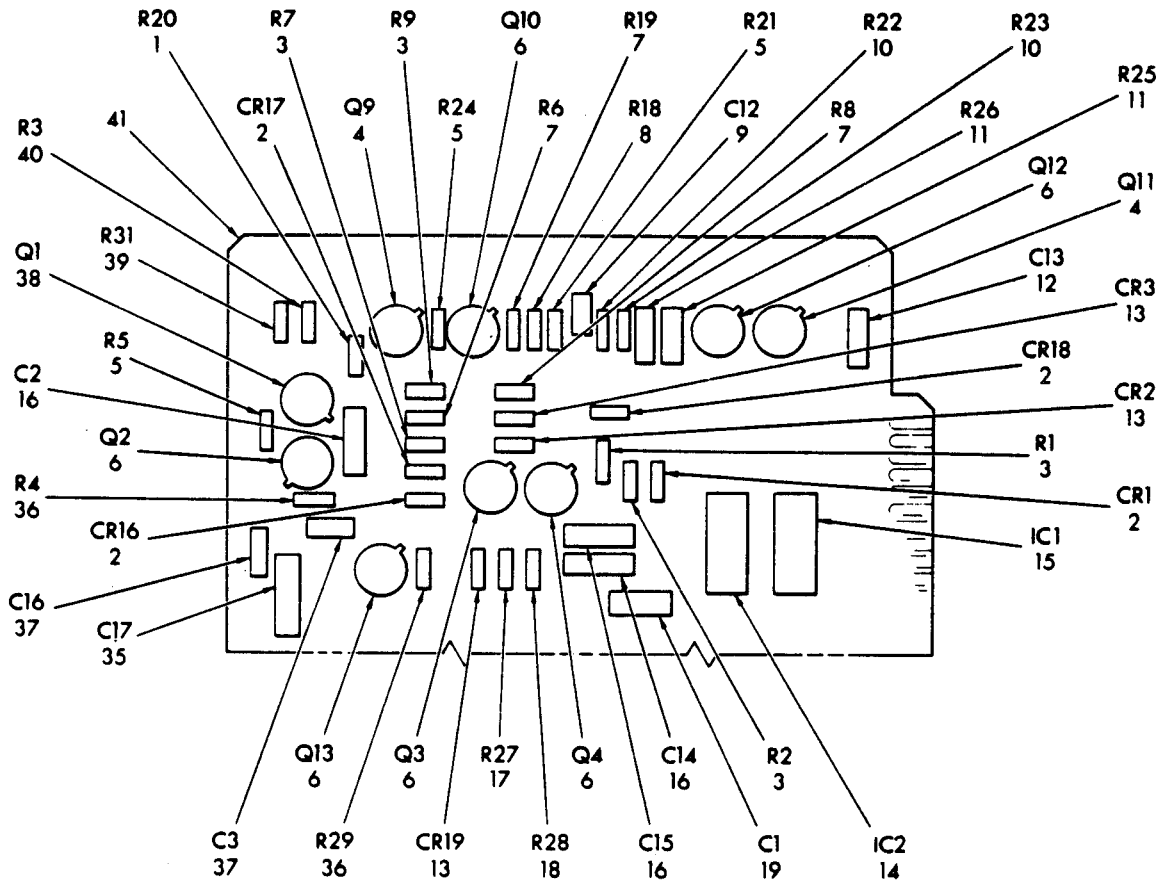
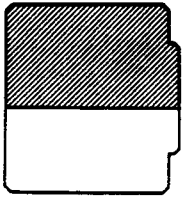

PREFIX ALL REF DES WITH: A3

EL8AX011

Figure 9. Circuit Card Assembly, Data Output Circuits, Hi-Low Level (A3), 80372030-000 (Sheet 1 of 2)

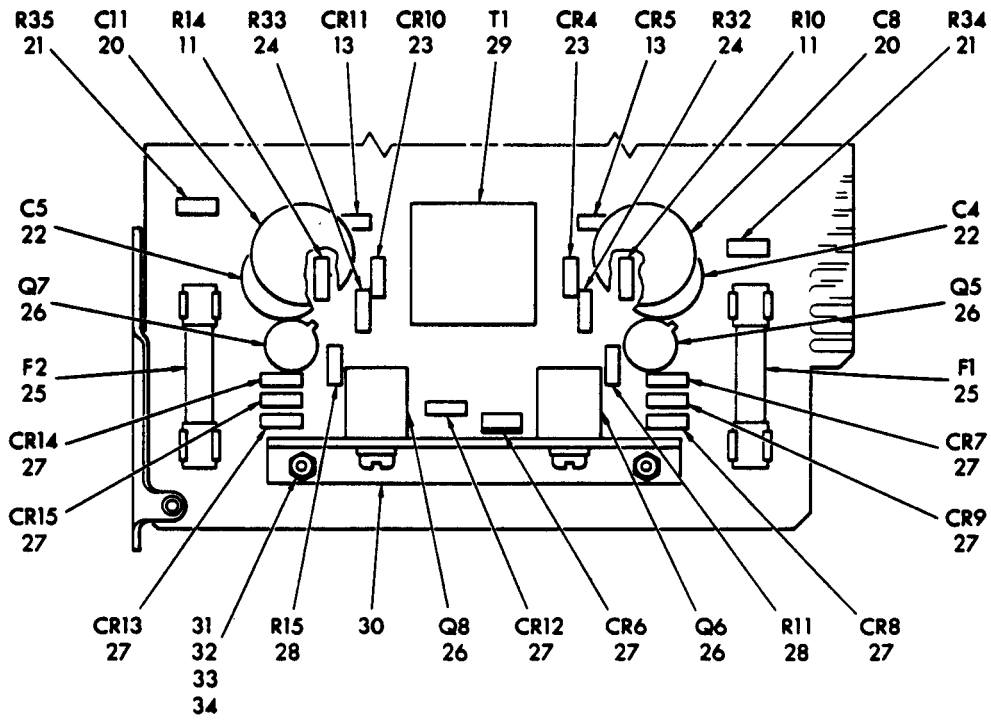
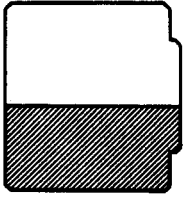

ELBAX012

Figure 9. Circuit Card Assembly, Data Output Circuits, Hi-Low Level (A3), 80372030-000 (Sheet 2 of 2)

SECTION II		(2)	(3)	(4)	(5)	(6)	(7)	(8)
(1)	ILLUSTRATION		NATIONAL		PART			QTY
(a)	(b)		STOCK		NUMBER			INC
FIG	ITEM	SMR	NUMBER	FSCM			USABLE ON CODE	IN
NO	NO	CODE			NUMBER			UNIT
GROUP 07 CIRCUIT CARD ASSY, DATA OUTPUT								
CIRCUITS HI-LOW LEVEL (A3)								
80372030-000								
9	1	PAHZZ	5905-00-136-3890	81349	RCR07G513JS	RESISTOR, FIXED, COMP		EA 1
9	2	PAHZZ	5961-00-669-6884	81349	JAN1N277	SEMICONDUCTOR DEVIC		EA 4
9	3	PAHZZ	5905-00-104-8360	81349	RCR07G623JS	RESISTOR, FIXED, COMP		EA 4
9	4	PAHZZ	5961-00-951-8757	81349	JAN2N2222A	TRANSISTOR		EA 2
9	5	PAHZZ	5905-00-431-7828	81349	RNC55K1501FS	RESISTOR, FIXED, FILM		EA 3
9	6	PAHZZ	5961-00-949-1440	81349	JAN2N2905A	TRANSISTOR		EA 6
9	7	PAHZZ	5905-00-110-7622	81349	RCR07G682JS	RESISTOR, FIXED, COMP		EA 3
9	8	PAHZZ	5905-00-106-9356	81349	RCR07G203JS	RESISTOR, FIXED, COMP		EA 1
9	9	PAHZZ	5910-01-043-6899	81349	CMR05F121GODR	CAPACITOR, FIXED, MIC		EA 1
9	10	PAHZZ	5905-00-432-6388	81349	RNC55K6191FS	RESISTOR, FIXED, FILM		EA 2
9	11	PAHZZ	5905-00-110-0196	81349	RCR20G102JS	RESISTOR, FIXED, COMP		EA 4
9	12	PAHZZ	5910-00-236-8740	81349	M39003/01-2974	CAPACITOR, FIXED, ELE		EA 1
9	13	PAHZZ	5961-00-842-9864	81349	JAN1N914	SEMICONDUCTOR DEVIC		EA 5
9	14	PAHZZ	5962-00-819-2215	01295	SN15846N	MICROCIRCUIT, DIGITA		EA 1
9	15	PAHZZ	5962-00-011-3010	01295	SN15845N	MICROCIRCUIT, DIGITA		EA 1
9	16	PAHZZ	5910-00-822-5682	56289	5GAD10	7CAPACITOR, FIXED, CE		EA 3
9	17	PAHZZ	5905-00-104-8369	81349	RCR07G362JS	RESISTOR, FIXED, COMP		EA 1
9	18	PAHZZ	5905-00-119-3505	81349	RCR07G683JS	RESISTOR, FIXED, COMP		EA 1
9	19	PADZZ	5910-00-864-8387	56289	C023B102F202M	CAPACITOR, FIXED, CER		EA 1
9	20	XDHZZ	5910-00-244-7312	84171	CCD153	CAPACITOR, FIXED, CER		EA 2
9	21	PAHZZ	5905-00-131-9729	81349	RCR07G302JS	RESISTOR, FIXED, COMP		EA 2
9	22	PAHZZ	5910-00-577-3281	56289	TGS50	CAPACITOR, FIXED, CER		EA 2
9	23	PAHZZ	5961-00-847-5246	81349	JAN1N746A	SEMICONDUCTOR DEVIC		EA 2
9	24	PAHZZ	5905-00-111-1679	81349	RCR07G512JS	RESISTOR, FIXED, COMP		EA 2
9	25	PAHZZ	5920-00-284-9493	81349	F02A250V1-8AS	FUSE, CARTRIDGE		EA 2
9	26	PAHZZ	5961-00-584-2365	96238	40001213-000	TRANSISTOR		EA 4
9	27	PAHZZ	5961-00-985-4900	81349	JAN1N647	SEMICONDUCTOR DEVIC		EA 8
9	28	PAHZZ	5905-00-141-1183	81349	RCR07G101JS	RESISTOR, FIXED, COMP		EA 2
9	29	PAHZZ	5950-00-450-8095	96238	43003041-000	TRANSFORMER, PULSE		EA 1
9	30	XBHZZ		96238	62021582-000	BRACKET, ANGLE		EA 1
9	31	PAHZZ	5310-00-934-9748	96906	MS35649-244	NUT, PLAIN, HEXAGON		EA 2
9	32	PAHZZ	5310-00-933-8118	96906	MS35338-135	WASHER, LOCK		EA 2
9	33	PAHZZ	5310-00-595-6211	96906	MS15795-803	WASHER, FLAT		EA 2
9	34	PAHZZ	5305-00-054-5649	96906	MS51957-15	SCREW, MACHINE		EA 2
9	35	PAHZZ		81349	CSR13F475KM	CAPACITOR, FIXED, ELE		EA 1
9	36	PAHZZ	5905-00-110-7620	81349	RCR07G102JS	RESISTOR, FIXED, COMP		EA 2
9	37	PAHZZ		91418	TA01UFPORM35PCT	CAPACITOR, FIXED, CE		EA 2

SECTION II

(1)	(2)	(3)	(4)	(5)	(6)	(7)	(8)
ILLUSTRATION					DESCRIPTION		QTY
(a)	(b)	NATIONAL					INC
FIG	ITEM	SMR	STOCK	PART			IN
NO	NO	CODE	NUMBER	FSCM	NUMBER	USABLE ON CODE	U/M
							UNIT
9	38	PAHZZ	5961-00-902-1177	80131	2N2646		EA 1
9	39	PAHZZ	5905-00-106-3666	81349	RCR07G103JS		EA 1
9	40	PAHZZ	5905-00-118-4559	81349	RCR07G333JS		EA 1
9	41	XAHZZ		96238	80372032F		EA 1

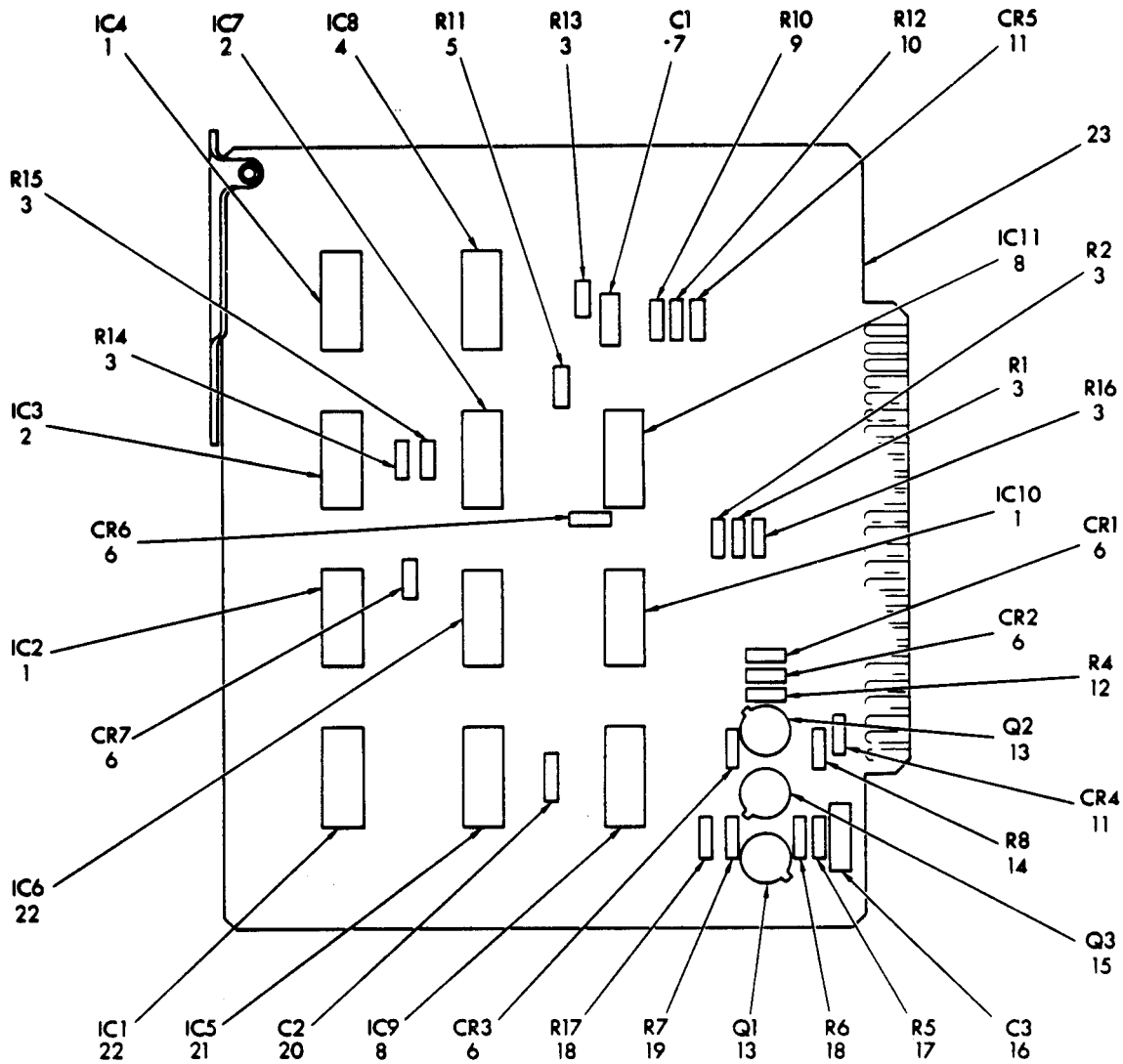

PREFIX ALL REF DES WITH: A4

ELBA X013

Figure 10. Circuit Card Assembly, Message Control Circuits (A4), 80372040-000

SECTION II		(2)	(3)	(4)	(5)	(6)	(7)	(8)
(1)	ILLUSTRATION		NATIONAL		PART	DESCRIPTION		QTY
(a)	(b)		STOCK		NUMBER			INC
FIG	ITEM	SMR	NUMBER	FSCM			USABLE ON CODE	IN
NO	NO	CODE						UNIT
GROUP 08 CIRCUIT CARD ASSY, MESSAGE CONTROL								
CIRCUITS (A4) 80372040-000								
10	1	PAHZZ	5962-00-011-2962	01295	SN15830N	MICROCIRCUIT, DIGITA		EA 3
10	2	PAHZZ	5962-00-193-0323	01295	SN15836N	MICROCIRCUIT, DIGITA		EA 2
10	3	PAHZZ	5905-00-106-3666	81349	RCR07G103JS	RESISTOR, FIXED, COMP		EA 6
10	4	PAHZZ	5962-00-350-8429	80063	SM-B-525285	MICROCIRCUIT, DIGITA		EA 1
10	5	PAHZZ	5905-00-115-8055	81349	RCR07G393JS	RESISTOR, FIXED, COMP		EA 1
10	6	PAHZZ	5961-00-842-9864	81349	JAN1N914	SEMICONDUCTOR DEVIC		EA 5
10	7	PAHZZ	5910-00-864-8387	56289	C0238102F202M	CAPACITOR, FIXED, CER		EA 1
10	8	PAHZZ	5962-00-420-6545	01295	SN158099N	MICROCIRCUIT, DIGITA		EA 2
10	9	PAHZZ	5905-00-135-3973	81349	RCR07G221JS	RESISTOR, FIXED, COMP		EA 1
10	10	PAHZZ	5905-00-104-8360	81349	RCR07G623JS	RESISTOR, FIXED, COMP		EA 1
10	11	PAHZZ	5961-00-669-6884	81349	JAN1N277	SEMICONDUCTOR DEVIC		EA 2
10	12	PAHZZ	5905-00-110-7622	81349	RCR07G682JS	RESISTOR, FIXED, COMP		EA 1
10	13	PAHZZ	5961-00-226-8579	81349	JAN2N930	TRANSISTOR		EA 2
10	14	PAHZZ	5905-00-228-5506	81349	RCR07G622JS	RESISTOR, FIXED, COMP		EA 1
10	15	PAHZZ	5961-00-925-3777	81349	JAN2N2907A	TRANSISTOR		EA 1
10	16	PAHZZ	5910-00-236-8740	81349	M39003/01-2974	CAPACITOR, FIXED, ELE		EA 1
10	17	PAHZZ	5905-00-116-8555	81349	RCR07G153JS	RESISTOR, FIXED, COMP		EA 1
10	18	PAHZZ	5905-00-106-1356	81349	RCR07G152JS	RESISTOR, FIXED, COMP		EA 2
10	19	PAHZZ	5905-00-116-8556	81349	RCR07G223JS	RESISTOR, FIXED, COMP		EA 1
10	20	PAHZZ		91418	TA01UFPORM35PCT	CAPACITOR, FIXED, CE		EA 1
10	21	PAHZZ	5962-00-250-9267	01295	SN7492AN	MICROCIRCUIT, DIGITA		EA 1
10	22	PAHZZ	5962-00-819-2215	01295	SN15846N	MICROCIRCUIT, DIGITA		EA 2
10	23	XAHZZ		96238	80372042G	PRINTED WIRING BD		EA 1

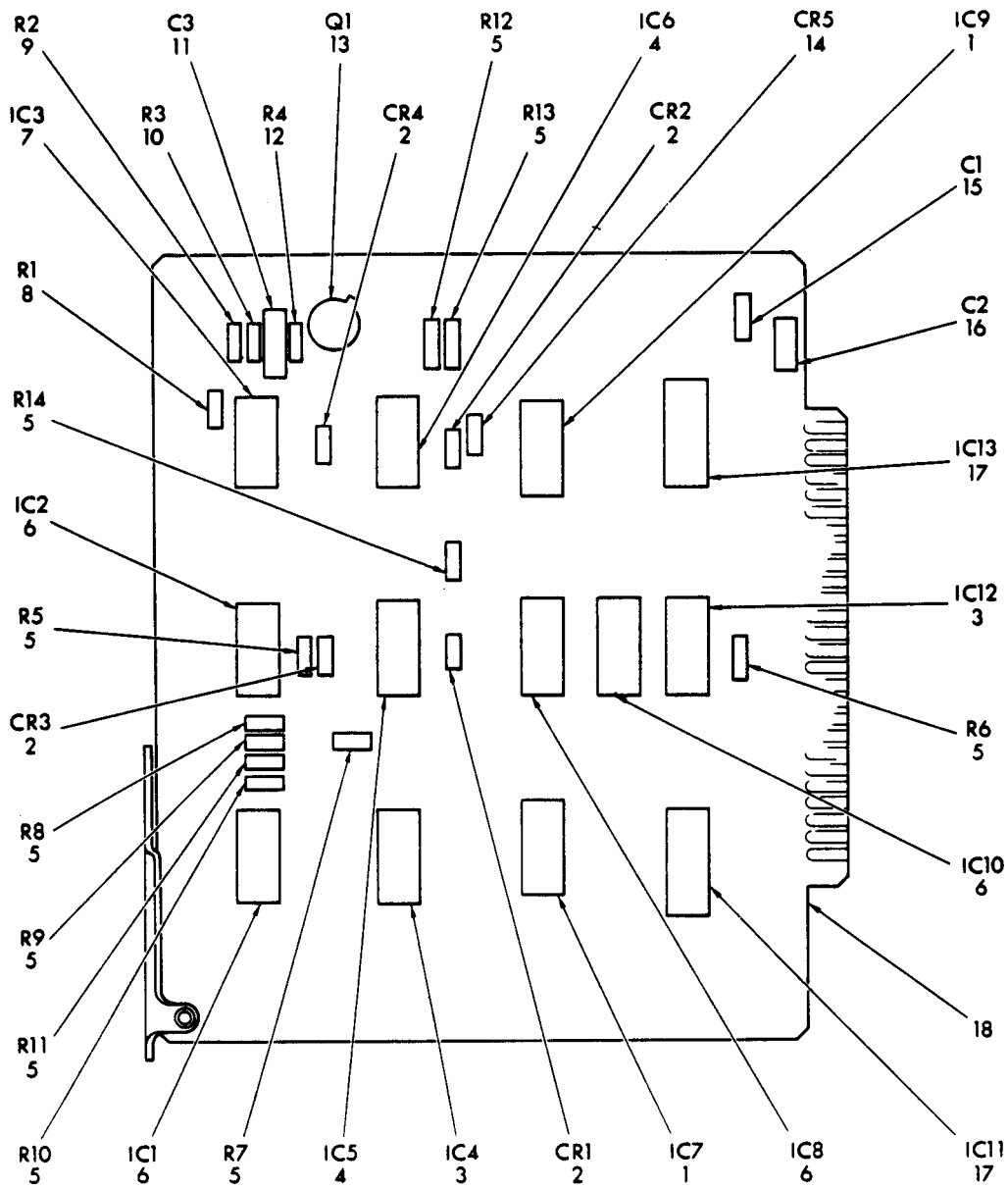

PREFIX ALL REF DES WITH: A5

ELBAX014

Figure 11. Circuit Card Assembly, Distortion Generator (AS), 80372050-000

SECTION II

(1)	(2)	(3)	(4)	(5)	(6)	(7)	(8)
ILLUSTRATION					DESCRIPTION		QTY
(a)	(b)	NATIONAL		PART			INC
FIG	ITEM	SMR	STOCK			USABLE ON CODE	IN
NO	NO	CODE	NUMBER	FSCM	NUMBER		UNIT
GROUP 09 CIRCUIT CARD ASSY, DISTORTION							
GENERATOR (A5),80372050-000							
11	1	PAHZZ	5962-00-430-2600	81349	M38510/01307BCB		EA 2
11	2	PAHZZ	5961-00-842-9864	81349	JAN1N914		EA 4
11	3	PAHZZ	5962-00-819-2215	01295	SN15846N		EA 2
11	4	PAHZZ	5962-00-011-2962	01295	SN15830N		EA 2
11	5	PAHZZ	5905-00-106-3666	81349	RCR07G103JS		EA 10
11	6	PAHZZ	5962-00-193-0323	01295	SN15836N		EA 4
11	7	PAHZZ	5962-00-350-8429	80063	SM-B-525285		EA 1
11	8	PAHZZ	5905-00-114-0708	81349	RCR07G202JS		EA 1
11	9	PAHZZ	5905-00-111-1679	81349	RCR07G512JS		EA 1
11	10	PAHZZ	5905-00-135-3973	81349	RCR07G221JS		EA 1
11	11	PAHZZ	5910-01-043-6892	81349	CMR05F101GODR		EA 1
11	12	PAHZZ	5905-00-131-1255	81349	RCR07G122JS		EA 1
11	13	PAHZZ	5961-00-954-6100	81349	JAN2N708		EA 1
11	14	PAHZZ	5961-00-669-6884	81349	JAN1N277		EA 1
11	15	PAHZZ		91418	TA01UFPFORM35PCT		EA 1
11	16	PAHZZ	5910-00-236-8740	81349	M39003/01-2974		EA 1
11	17	PAHZZ	5962-00-428-7809	81349	M38510/01001BEB		EA 2
11	18	XAHZZ		96238	80372052D		EA 1

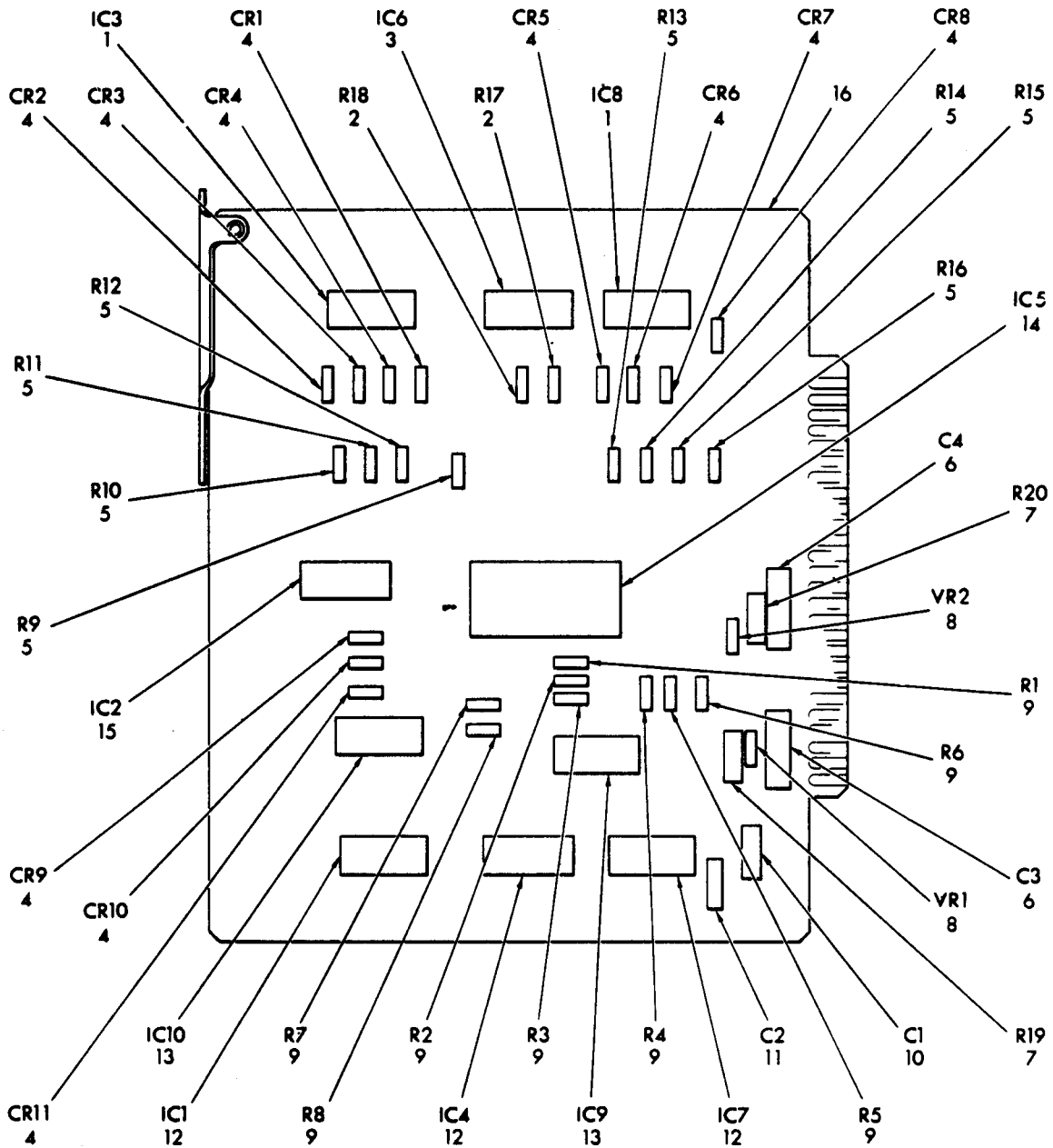

PREFIX ALL REF DES WITH: A6

ELBA015

Figure 12. Circuit Card Assembly, Message Generator (A6), 80372060-000

(1) ILLUSTRATION (a) FIG NO	(2) (b) ITEM NO	(3) SMR CODE	(3) NATIONAL STOCK NUMBER	(4) FSCM	(5) PART NUMBER	(6) DESCRIPTION	(7) USABLE ON CODE	(8) QTY INC IN UNIT
GROUP 10 CIRCUIT CARD ASSY, MESSAGE								
GENERATOR (A6) 80372060-000								
12	1	PAHZZ	5962-00-193-0323	01295	SN15836N	MICROCIRCUIT, DIGITA	EA	2
12	2	PAHZZ	5905-00-106-3666	81349	RCR07G103JS	RESISTOR, FIXED, COMP	EA	2
12	3	PAHZZ	5962-00-819-2215	01295	SN15846N	MICROCIRCUIT, DIGITA	EA	1
12	4	PAHZZ	5961-00-842-9864	81349	JAN1N914	SEMICONDUCTOR DEVIC	EA	11
12	5	PAHZZ	5905-00-141-1132	81349	RCR07G752JS	RESISTOR, FIXED, COMP	EA	8
12	6	PAHZZ		81349	CSR13F4R7KM	CAPACITOR, FIXED, ELE	EA	2
12	7	PAHZZ	5905-00-116-8566	81349	RCR20G680JS	RESISTOR, FIXED, COMP	EA	2
12	8	PAHZZ	5961-00-018-9195	80131	1N4742A	SEMICONDUCTOR DEVIC	EA	2
12	9	PAHZZ	5905-00-110-7622	81349	RCR07G682JS	RESISTOR, FIXED, COMP	EA	8
12	10	PAHZZ	5910-00-236-8740	81349	M39003/01-2974	CAPACITOR, FIXED, ELE	EA	1
12	11	PAHZZ		91418	TA01UFPFORM35PCT	CAPACITOR, FIXED, CE	EA	1
12	12	PAHZZ	5962-00-420-6545	01295	SN158099N	MICROCIRCUIT, DIGITA	EA	3
12	13	PAHZZ	5962-00-341-0544	81349	M38510/00105BCB	MICROCIRCUIT, DIGITA	EA	2
12	14	PAHZZ	5962-01-115-1687	27014	MM5220DF/N	MICROCIRCUIT, DIGITA	EA	1
12	15	PAHZZ	5962-00-011-2962	01295	SN15830N	MICROCIRCUIT, DIGITA	EA	1
12	16	XAHZZ		96238	80372062D	PRINTED WIRING BD	EA	1

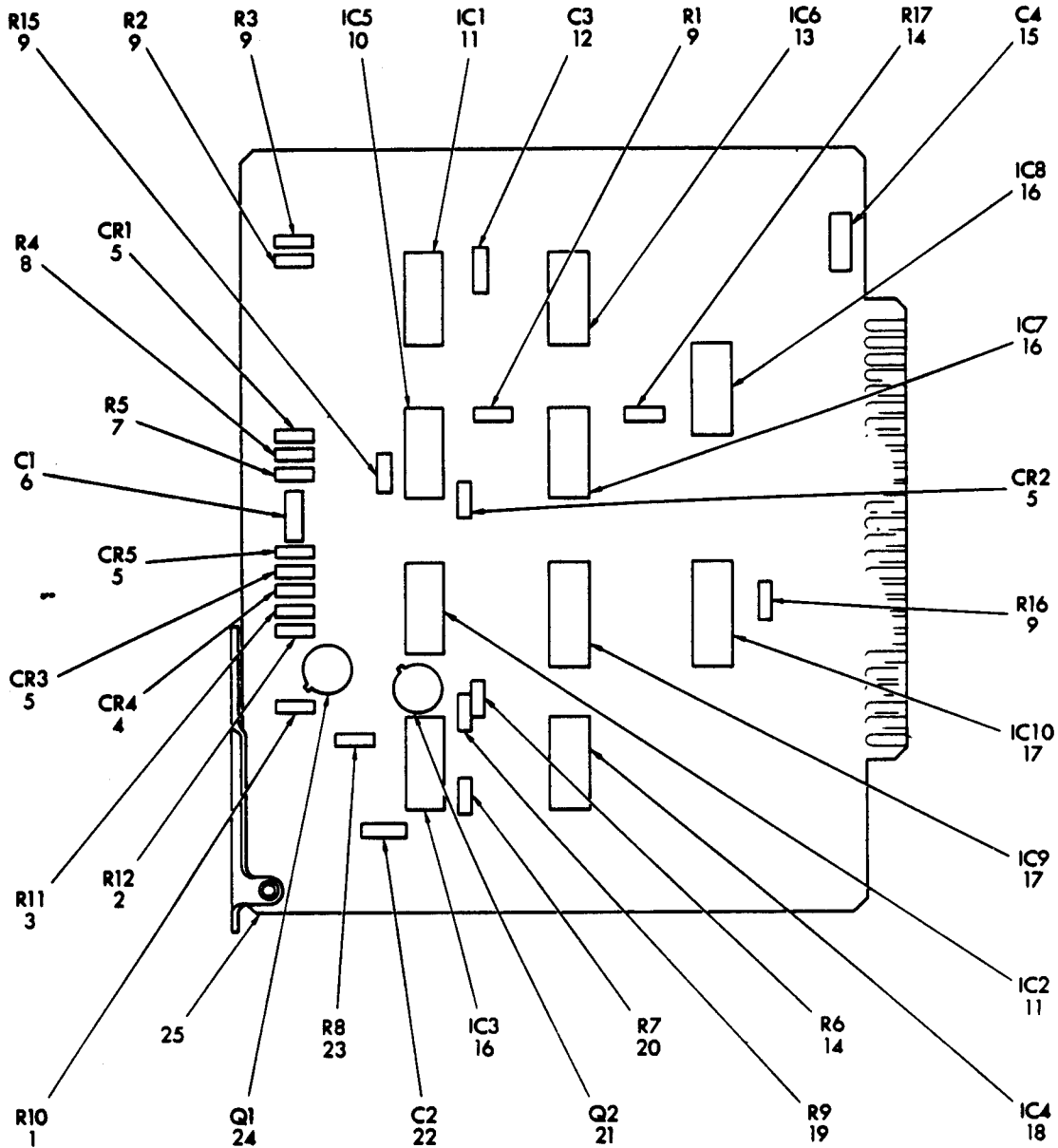

PREFIX ALL REF DES WITH: A7

ELBAX016

Figure 13. Circuit Card Assembly, Character Distribution and Timing Control (A7), 80372070-000

SECTION II

(1)	(2)	(3)	(4)	(5)	(6)	(7)	(8)
ILLUSTRATION					DESCRIPTION		QTY
(a)	(b)	NATIONAL		PART			INC
FIG	ITEM	STOCK		NUMBER		USABLE ON CODE	IN
NO	NO	NUMBER	FSCM	NUMBER			UNIT
GROUP 11 CIRCUIT CARD ASSY, CHARACTER							
DISTRIBUTION AND TIMING CONTROL							
(A7) 80372070-000							
13	1	PAHZZ 5905-00-105-7764	81349	RCR07G222JS	RESISTOR, FIXED, COMP		EA 1
13	2	PAHZZ 5905-00-110-7622	81349	RCR07G682JS	RESISTOR, FIXED, COMP		EA 1
13	3	PAHZZ 5905-00-110-0388	81349	RCR07G104JS	RESISTOR, FIXED, COMP		EA 1
13	4	PAHZZ 5961-00-842-9864	81349	JAN1N914	SEMICONDUCTOR DEVIC		EA 1
13	5	PAHZZ 5961-00-669-6884	81349	JAN1N277	SEMICONDUCTOR DEVIC		EA 4
13	6	PAHZZ 5910-00-864-8387	56289	C023B102F202M	CAPACITOR, FIXED, CER		EA 1
13	7	PAHZZ 5905-00-115-8055	81349	RCR07G393JS	RESISTOR, FIXED, COMP		EA 1
13	8	PAHZZ 5905-00-104-8360	81349	RCR07G623JS	RESISTOR, FIXED, COMP		EA 1
13	9	PAHZZ 5905-00-106-3666	81349	RCR07G103JS	RESISTOR, FIXED, COMP		EA 5
13	10	PAHZZ 5962-00-350-8429	80063	SM-B-525285	MICROCIRCUIT, DIGITA		EA 1
13	11	PAHZZ 5962-00-819-2215	01295	SN15846N	MICROCIRCUIT, DIGITA		EA 2
13	12	PAHZZ	91418	TA01UFPORM35PCT	CAPACITOR, FIXED, CE		EA 1
13	13	PAHZZ 5962-00-011-2962	01295	SN15830N	MICROCIRCUIT, DIGITA		EA 1
13	14	PAHZZ 5905-00-114-0708	81349	RCR07G202JS	RESISTOR, FIXED, FILM		EA 2
13	15	PAHZZ 5910-00-236-8740	81349	M39003/01-2974	CAPACITOR, FIXED, ELE		EA 1
13	16	PAHZZ 5962-00-193-0323	01295	SN15836N	MICROCIRCUIT, DIGITA		EA 3
13	17	PAHZZ 5962-00-404-6174	01295	SN7496N	MICROCIRCUIT, DIGITA		EA 2
13	18	PAHZZ 5962-00-927-1749	01295	SN15862N	MICROCIRCUIT, DIGITA		EA 1
13	19	PAHZZ 5905-00-131-1255	81349	RCR07G122JS	RESISTOR, FIXED, COMP		EA 1
13	20	PAHZZ 5905-00-135-3973	81349	RCR07G221JS	RESISTOR, FIXED, COMP		EA 1
13	21	PAHZZ 5961-00-954-6100	81349	JAN2N708	TRANSISTOR		EA 1
13	22	PAHZZ 5910-01-030-1770	81349	CMR05F151GODR	CAPACITOR, FIXED, MIC		EA 1
13	23	PAHZZ 5905-00-111-1679	81349	RCR07G512JS	RESISTOR, FIXED, COMP		EA 1
13	24	PAHZZ 5961-00-842-6937	81349	JAN2N706	TRANSISTOR		EA 1
13	25	XAHZZ	96238	80372072G	PRINTED WIRING BD		EA 1

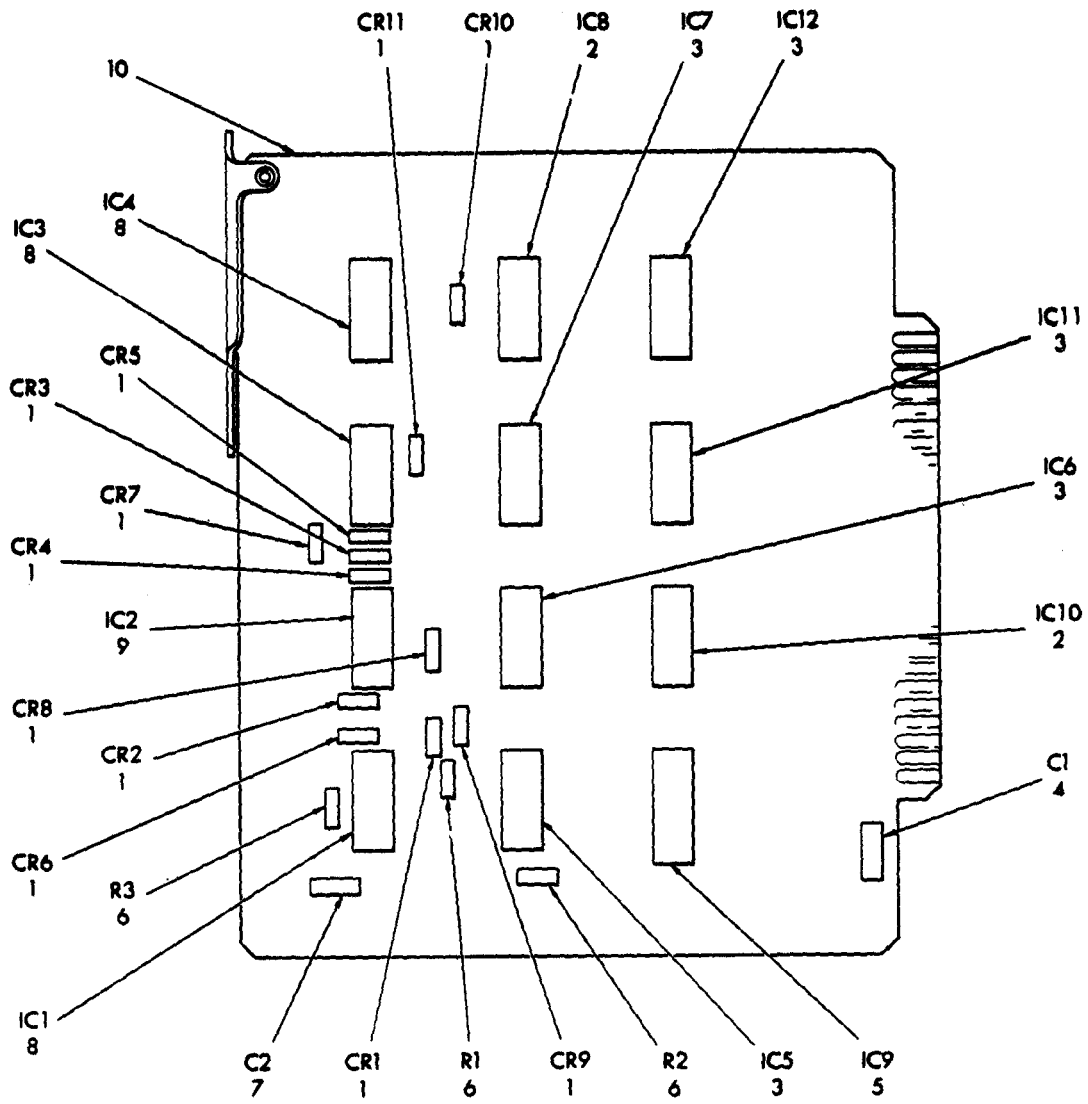

PREFIX ALL REF DES WITH: A8

ELBAXC:7

Figure 14. Circuit Card Assembly, Signal Pattern Matrix (A8), 80372080-000

SECTION II

(1)	(2)	(3)	(4)	(5)	(6)	(7)	(8)
ILLUSTRATION					DESCRIPTION		QTY
(a)	(b)	NATIONAL		PART			INC
FIG	ITEM	STOCK		NUMBER			IN
NO	NO	SMR	NUMBER	FSCM	NUMBER	USABLE ON CODE	U/M
CODE							UNIT
GROUP 12 CIRCUIT CARD ASSY, SIGNAL PATTERN							
MATRIX (AB), 80372080-000							
14	1	PAHZZ	5961-00-842-9864	81349	JAN1N914	SEMICONDUCTOR DEVIC	EA 11
14	2	PAHZZ	5962-00-193-0323	01295	SN15836N	MICROCIRCUIT, DIGITA	EA 2
14	3	PAHZZ	5962-00-819-2215	01295	SN15846N	MICROCIRCUIT, DIGITA	EA 5
14	4	PAHZZ	5910-00-236-8740	81349	M39003/01-2974	CAPACITOR, FIXED, ELE	EA 1
14	5	PAHZZ	5962-00-428-7809	81349	M38510/01001BEB	MICROCIRCUIT, DIGITA	EA 1
14	6	PAHZZ	5905-00-106-3666	81349	RCR07G103JS	RESISTOR, FIXED, COMP	EA 3
14	7	PAHZZ		91418	TA01UFPORM35PCT	CAPACITOR, FIXED, CE	EA 1
14	8	PAHZZ	5962-00-011-2962	01295	SN15830N	MICROCIRCUIT, DIGITA	EA 3
14	9	PAHZZ	5962-00-167-6316	04713	MC940L	MICROCIRCUIT, DIGITA	EA 1
14	10	XAHZZ		96238	80372082D	PRINTED WIRING BO	EA 1

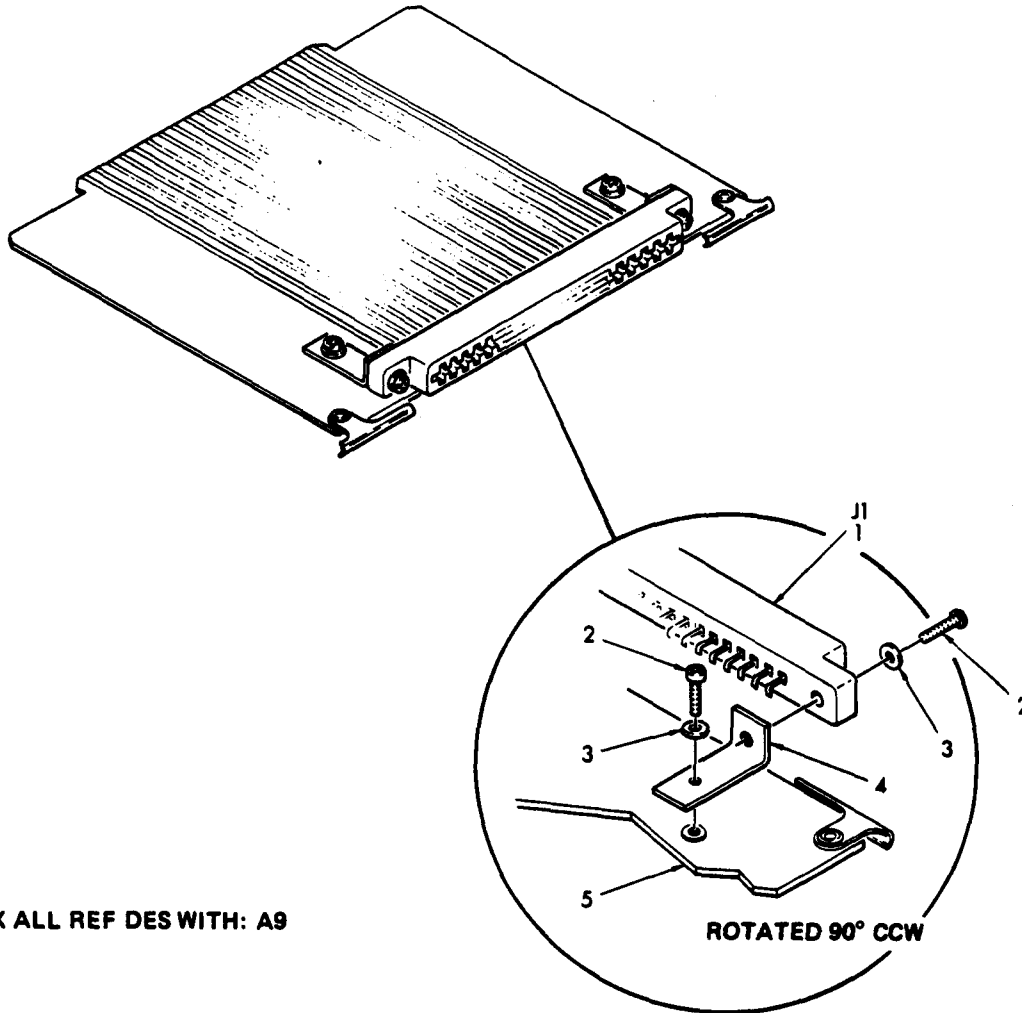

EL8AX018

Figure 15. Circuit Card Assembly, Extender (A9), 80372180-000

SECTION II

(1)	(2)	(3)	(4)	(5)	(6)	(7)	(8)
ILLUSTRATION					DESCRIPTION		QTY
(a)	(b)	NATIONAL					INC
FIG	ITEM	SMR	STOCK	PART			IN
NO	NO	CODE	NUMBER	FSCM	NUMBER	USABLE ON CODE	U/M
							UNIT
GROUP 13 CIRCUIT CARD ASSY, EXTENDER (A9),							
80372180-000							
15	1	PAHZZ	5935-00-135-8797	02660	225-22221-105	CONNECTOR, RECEPTACL	EA 1
15	2	PAHZZ	5305-00-054-5650	96906	MS51957-16	SCREW, MACHINE	EA 2
15	3	PAHZZ	5310-00-595-6211	96906	MS15795-803	WASHER, FLAT	EA 2
15	4	XBHZZ		96238	62021578000D	BRACKET, ANGLE	EA 2
15	5	XAHZZ		96236	80372182B	PRINTED WIRING BD	EA 1

SECTION IV

NATIONAL STOCK NUMBER AND PART NUMBER INDEX

NOTE: LATEST NATIONAL STOCK NUMBER AND PART NUMBER ASSIGNMENTS ARE INCLUDED AT END OF INDEX

STOCK NUMBER	FIGURE NO.	ITEM NO.	STOCK NUMBER	FIGURE NO.	ITEM NO.
6240-00-001-1524	1	12	5905-00-116-8555	10	17
5962-00-011-2962	10	1	5905-00-116-8556	10	19
5962-00-011-2962	11	4	5905-00-116-8566	12	7
5962-00-011-2962	12	15	5905-00-118-4559	9	40
5962-00-011-2962	13	13	5905-00-119-3505	9	18
5962-00-011-2962	14	8	5905-00-120-9154	8	24
5962-00-011-3010	9	15	5905-00-126-6683	7	1
5961-00-018-9195	12	8	5962-00-130-0353	6	15
5920-00-043-2641	4	24	5905-00-131-1255	11	12
5305-00-054-5637	4	17	5905-00-131-1255	13	19
5305-00-054-5646	1	28	5905-00-131-9729	6	7
5305-00-054-5647	6	1	5905-00-131-9729	7	4
5305-00-054-5648	1	31	5905-00-131-9729	9	21
5305-00-054-5648	2	2	5905-00-135-3973	10	9
5305-00-054-5648	3	11	5905-00-135-3973	11	10
5305-00-054-5649	8	33	5905-00-135-3973	13	20
5305-00-054-5649	8	43	5905-00-135-6046	8	12
5305-00-054-5649	9	34	5935-00-135-8797	15	1
5305-00-054-5650	15	2	5905-00-136-3890	9	1
5305-00-054-5651	3	13	5905-00-136-3891	8	27
5305-00-054-5651	5	6	5905-00-136-8406	7	15
5305-00-054-6650	4	15	5905-00-141-0717	6	25
5305-00-054-6651	1	37	5905-00-141-0742	8	21
5305-00-054-6652	1	56	5905-00-141-1132	12	5
5305-00-054-6652	4	2	5905-00-141-1183	7	17
5305-00-054-6652	4	11	5905-00-141-1183	9	28
5305-00-054-6661	4	8	5910-00-144-4383	8	14
5310-00-058-3599	8	32	5955-00-146-3855	3	9
5930-00-059-3399	1	3	5905-00-156-0435	8	7
5905-00-081-7348	8	40	5962-00-163-4166	6	9
5940-00-082-4814	4	20	5962-00-167-6316	14	9
5961-00-087-6047	8	3	5962-00-184-8205	6	11
5905-00-104-8358	7	14	5961-00-188-4279	7	10
5905-00-104-8360	9	3	5962-00-193-0323	10	2
5905-00-104-8360	10	10	5962-00-193-0323	11	6
5905-00-104-8360	13	8	5962-00-193-0323	12	1
5905-00-104-8369	9	17	5962-00-193-0323	13	16
5905-00-105-7764	6	22	5962-00-193-0323	14	2
5905-00-105-7764	8	17	6625-00-205-0294	1	46
5905-00-105-7764	13	1	6625-00-205-0298	1	40
5905-00-105-7768	8	19	6625-00-205-0299	1	47
5905-00-106-1356	8	15	6625-00-207-9851	1	41
5905-00-106-1356	10	18	6625-00-207-9922	1	48
5905-00-106-3666	6	12	6625-00-207-9930	1	49
5905-00-106-3666	7	13	6625-00-209-5333	1	2
5905-00-106-3666	9	39	6625-00-213-2620	1	43
5905-00-106-3666	10	3	6625-00-213-2621	1	51
5905-00-106-3666	11	5	6625-00-213-2624	1	42
5905-00-106-3666	12	2	6625-00-213-2686	1	50
5905-00-106-3666	13	9	5961-00-226-8579	8	26
5905-00-106-3666	14	6	5961-00-226-8579	10	13
5905-00-106-9356	9	8	5905-00-228-5506	10	14
5910-00-109-1987	4	13	5940-00-229-6900	4	26
5905-00-110-0196	9	11	5955-00-233-7287	3	8
5905-00-110-0388	13	3	5955-00-233-7288	3	6
5905-00-110-7620	3	2	5905-00-233-9202	8	28
5905-00-110-7620	6	17	5910-00-236-8740	6	14
5905-00-110-7620	8	5	5910-00-236-8740	9	12
5905-00-110-7620	8	10	5910-00-236-8740	10	16
5905-00-110-7620	9	36	5910-00-236-8740	11	16
5905-00-110-7622	6	19	5910-00-236-8740	12	10
5905-00-110-7622	8	9	5910-00-236-8740	13	15
5905-00-110-7622	9	7	5910-00-236-8740	14	4
5905-00-110-7622	10	12	5910-00-241-1424	3	3
5905-00-110-7622	12	9	5910-00-244-7312	9	20
5905-00-110-7622	13	2	5962-00-250-9267	10	21
5905-00-111-1679	7	12	5920-00-284-9493	8	4
5905-00-111-1679	9	24	5920-00-284-9493	9	25
5905-00-111-1679	11	9	5920-00-284-9494	8	1
5905-00-111-1679	13	23	5905-00-308-6636	8	25
5905-00-111-8357	8	36	5962-00-341-0544	12	13
5905-00-114-0708	7	8	5962-00-350-8429	10	4
5905-00-114-0708	11	8	5962-00-350-8429	11	7
5905-00-114-0708	13	14	5962-00-350-8429	13	10
5905-00-114-5388	8	16	5962-00-365-5728	6	24
5905-00-115-3560	7	2	5305-00-400-8531	1	53
5905-00-115-8055	7	7	5962-00-404-6174	13	17
5905-00-115-8055	10	5	5962-00-405-8465	6	18
5905-00-115-8055	13	7	5305-00-411-0683	4	16
5905-00-116-8555	7	16	5962-00-420-6545	6	10

NATIONAL STOCK NUMBER AND PART NUMBER INDEX

STOCK NUMBER	FIGURE NO.	ITEM NO.	STOCK NUMBER	FIGURE NO.	ITEM NO.		
5962-00-420-6545	10	8	5920-00-892-9311	4	25		
5962-00-420-6545	12	12	5935-00-893-3935	1	9		
5962-00-428-7809	11	17	5940-00-901-4899	4	19		
5962-00-428-7809	14	5	5961-00-902-1177	9	38		
5962-00-430-2600	11	1	5930-00-902-2395	4	22		
5905-00-431-7828	9	5	5961-00-925-3777	7	18		
5905-00-432-6388	9	10	5961-00-925-3777	10	15		
5310-00-445-8845	1	32	5962-00-927-1749	13	18		
5950-00-450-8095	9	29	5910-00-927-5130	8	2		
5910-00-495-0042	8	34	5310-00-929-6395	1	30		
5935-00-563-1173	5	1	5310-00-929-6395	4	10		
5910-00-577-3281	9	22	5310-00-929-6395	4	12		
5935-00-581-6941	3	14	5310-00-933-8118	1	6		
5961-00-584-2365	9	26	5310-00-933-8118	1	27		
5310-00-595-6211	1	65	5310-00-933-8118	2	5		
5310-00-595-6211	2	3	5310-00-933-8118	3	12		
5310-00-595-6211	5	5	5310-00-933-8118	5	4		
5310-00-595-6211	6	3	5310-00-933-8118	6	2		
5310-00-595-6211	8	31	5310-00-933-8118	8	30		
5310-00-595-6211	8	42	5310-00-933-8118	9	32		
5310-00-595-6211	9	33	5310-00-934-0226	4	18		
5310-00-595-6211	15	3	5310-00-934-9748	1	5		
5940-00-615-2282	1	16	5310-00-934-9748	1	57		
5935-00-665-5718	4	23	5310-00-934-9748	2	6		
5961-00-669-6884	6	23	5310-00-934-9748	3	15		
5961-00-669-6884	9	2	5310-00-934-9748	5	3		
5961-00-669-6884	10	11	5310-00-934-9748	8	29		
5961-00-669-6884	11	14	5310-00-934-9748	8	41		
5961-00-669-6884	13	5	5310-00-934-9748	9	31		
5905-00-682-4142	8	39	5310-00-934-9761	1	29		
5940-00-688-2770	1	17	5310-00-934-9761	4	4		
5910-00-689-8751	7	9	5935-00-937-4219	4	14		
5310-00-722-5998	1	38	5961-00-949-1440	8	8		
5310-00-722-5998	4	5	5961-00-949-1440	9	6		
5310-00-725-1893	1	8	5961-00-951-8757	6	8		
5961-00-752-6136	8	35	5961-00-951-8757	7	19		
5305-00-763-6962	1	35	5961-00-951-8757	9	4		
5305-00-763-6963	1	24	5961-00-954-6100	11	13		
5305-00-763-7822	1	61	5961-00-954-6100	13	21		
5305-00-770-2533	1	1	5310-00-963-9950	6	5		
5961-00-813-9360	8	22	5905-00-975-1139	4	9		
5962-00-819-2215	6	16	5961-00-978-5966	8	37		
5962-00-819-2215	9	14	5961-00-985-4900	9	27		
5962-00-819-2215	10	22	5961-00-995-2310	8	11		
5962-00-819-2215	11	3	5955-01-009-4538	3	7		
5962-00-819-2215	12	3	5935-01-009-5653	1	7		
5962-00-819-2215	13	11	5930-01-009-7615	1	11		
5962-00-819-2215	14	3	5930-01-010-7648	1	26		
5910-00-822-5682	9	16	5930-01-013-7293	1	4		
5910-00-828-7905	4	1	5930-01-013-7294	1	20		
5961-00-842-6937	6	21	5930-01-013-8409	1	21		
5961-00-842-6937	7	11	5930-01-013-8410	1	10		
5961-00-842-6937	13	24	5930-01-013-8411	1	19		
5961-00-842-9864	2	9	5910-01-030-1770	13	22		
5961-00-842-9864	6	20	5910-01-030-9211	8	18		
5961-00-842-9864	7	5	5910-01-043-6892	11	11		
5961-00-842-9864	9	13	5910-01-043-6899	9	9		
5961-00-842-9864	10	6	5950-01-046-6968	4	6		
5961-00-842-9864	11	2	5910-01-052-8905	8	23		
5961-00-842-9864	12	4	5961-01-058-2331	8	13		
5961-00-842-9864	13	4	5905-01-067-4616	8	38		
5961-00-842-9864	14	1	6625-01-098-1367	1	44		
5961-00-847-5246	9	23	5930-01-098-7058	2	1		
5961-00-847-5247	8	20	5962-01-115-1687	12	14		
5910-00-864-8387	9	19	5930-01-115-4083	3	5		
5910-00-864-8387	10	7	5930-01-123-5287	1	15		
5910-00-864-8387	13	6					
FSCM	PART NUMBER	FIGURE NO.	ITEM NO.	FSCM	PART NUMBER	FIGURE NO.	ITEM NO.
84171	CCD153	9	20	81349	CSR13F4R7KM	12	6
81349	CK63AY103M	4	13	81349	CSR13F475KM	9	35
81349	CMR05F101GODR	11	11	81349	CSR13G105KS	8	34
81349	CMR05F121GODR	9	9	56289	C023B102F202M	9	19
81349	CMR05F151GODR	13	22	56289	C023B102F202M	10	7
81349	CMR06F472GODR	8	18	56289	C023B102F202M	13	6
81349	CMR06F561GODR	8	23	03508	C106Q21	8	13
81349	CSR13F156KM	8	6	71450	C212-26036-2-1	3	5

SECTION IV
 TM11-6625-2921-24P/E2137-BV-PLL-060/5103 SG-1054/TO 33A1-8-883-4
 NATIONAL STOCK NUMBER AND PART NUMBER INDEX

FSCM	PART NUMBER	FIGURE NO.	ITEM NO.	FSCM	PART NUMBER	FIGURE NO.	ITEM NO.
81349	FHN26G1	4	25	96906	MS35649-264	4	4
81349	F02A250V1-4A	4	24	96906	MS51957-12	1	28
81349	F02A250V1-8AS	8	4	96906	MS51957-121	1	53
81349	F02A250V1-8AS	9	25	96906	MS51957-123	4	16
81349	F02A250V3-4AS	8	1	96906	MS51957-13	6	1
81349	JAN1N1614	8	37	96906	MS51957-14	1	31
81349	JAN1N227	7	6	96906	MS51957-14	2	2
81349	JAN1N277	6	23	96906	MS51957-14	3	11
81349	JAN1N277	9	2	96906	MS51957-15	8	33
81349	JAN1N277	10	11	96906	MS51957-15	8	43
81349	JAN1N277	11	14	96906	MS51957-15	9	34
81349	JAN1N277	13	5	96906	MS51957-16	15	2
81349	JAN1N645	8	3	96906	MS51957-17	3	13
81349	JAN1N647	9	27	96906	MS51957-17	5	6
81349	JAN1N746A	9	23	96906	MS51957-26	4	15
81349	JAN1N748A	8	20	96906	MS51957-27	1	37
81349	JAN1N752A	8	11	96906	MS51957-28	1	56
81349	JAN1N914	2	9	96906	MS51957-28	4	2
81349	JAN1N914	6	20	96906	MS51957-28	4	11
81349	JAN1N914	7	5	96906	MS51957-3	4	17
81349	JAN1N914	9	13	96906	MS51957-37	4	8
81349	JAN1N914	10	6	96906	MS51959-13	1	1
81349	JAN1N914	11	2	96906	MS51959-14	1	61
81349	JAN1N914	12	4	96906	MS51959-27	1	35
81349	JAN1N914	13	4	96906	MS51959-28	1	24
81349	JAN1N914	14	1	81349	M21097/21-145	5	1
81349	JAN2N1011	8	35	81349	M38510/00105BCB	12	13
81349	JAN2N1613	8	22	81349	M38510/01001BEB	11	17
81349	JAN2N2222A	6	8	81349	M38510/01001BEB	14	5
81349	JAN2N2222A	7	19	81349	M38510/01302BCB	6	24
81349	JAN2N2222A	9	4	81349	M38510/01307BCB	11	1
81349	JAN2N2905A	8	8	81349	M39003/01-2974	6	14
81349	JAN2N2905A	9	6	81349	M39003/01-2974	9	12
81349	JAN2N2907A	7	18	81349	M39003/01-2974	10	16
81349	JAN2N2907A	10	15	81349	M39003/01-2974	11	16
81349	JAN2N706	6	21	81349	M39003/01-2974	12	10
81349	JAN2N706	7	11	81349	M39003/01-2974	13	15
81349	JAN2N706	13	24	81349	M39003/01-2974	14	4
81349	JAN2N708	11	13	81349	M39003/01-3026	8	14
81349	JAN2N708	13	21	96238	NO PART NO-1	1	36
81349	JAN2N930	8	26	96238	NO PART NO-1	1	58
81349	JAN2N930	10	13	96238	NO PART NO-2	3	16
22753	LRSW322N1250CRSS	1	15	96238	NO PART NO-3	4	3
04713	MC858P	6	11	96238	NO PART NO-5	2	7
04713	MC940L	14	9	96238	NO PART NO-6	3	4
27014	MM5220DF/N	12	14	82389	N112A	1	9
95146	MSP105F	1	3	21604	PS70D95C1BLK	1	55
95146	MST105D	4	22	21604	PS70D95C2BLK	1	34
96906	MS15795-803	1	65	21604	PS70D95C2BLK	1	54
96906	MS15795-803	2	3	81349	RCR07G101JS	7	17
96906	MS15795-803	5	5	81349	RCR07G101JS	9	28
96906	MS15795-803	6	3	81349	RCR07G102JS	3	2
96906	MS15795-803	8	31	81349	RCR07G102JS	6	17
96906	MS15795-803	8	42	81349	RCR07G102JS	8	5
96906	MS15795-803	9	33	81349	RCR07G102JS	8	10
96906	MS15795-803	15	3	81349	RCR07G102JS	9	36
96906	MS15795-805	1	38	81349	RCR07G103JS	6	12
96906	MS15795-805	4	5	81349	RCR07G103JS	7	13
96906	MS35335-57	8	32	81349	RCR07G103JS	9	39
96906	MS35338-135	1	6	81349	RCR07G103JS	10	3
96906	MS35338-135	1	27	81349	RCR07G103JS	11	5
96906	MS35338-135	2	5	81349	RCR07G103JS	12	2
96906	MS35338-135	3	12	81349	RCR07G103JS	13	9
96906	MS35338-135	5	4	81349	RCR07G103JS	14	6
96906	MS35338-135	6	2	81349	RCR07G104JS	13	3
96906	MS35338-135	8	30	81349	RCR07G122JS	11	12
96906	MS35338-135	9	32	81349	RCR07G122JS	13	19
96906	MS35338-136	1	30	81349	RCR07G152JS	8	15
96906	MS35338-136	4	10	81349	RCR07G152JS	10	18
96906	MS35338-136	4	12	81349	RCR07G153JS	7	16
96906	MS35338-153	4	18	81349	RCR07G153JS	10	17
96906	MS35649-244	1	5	81349	RCR07G181JS	8	21
96906	MS35649-244	1	57	81349	RCR07G183JS	7	2
96906	MS35649-244	2	6	81349	RCR07G202JS	7	8
96906	MS35649-244	3	15	81349	RCR07G202JS	11	8
96906	MS35649-244	5	3	81349	RCR07G202JS	13	14
96906	MS35649-244	8	29	81349	RCR07G203JS	9	8
96906	MS35649-244	8	41	81349	RCR07G221JS	10	9
96906	MS35649-244	9	31	81349	RCR07G221JS	11	10
96906	MS35649-264	1	29	81349	RCR07G221JS	13	20

SECTION IV
 TM11-6625-2921-24P/E2137-BV-PLL-060/5103 SG-1054/TO 33A1-8-883-4
 NATIONAL STOCK NUMBER AND PART NUMBER INDEX

FSCM	PART NUMBER	FIGURE NO.	ITEM NO.	FSCM	PART NUMBER	FIGURE NO.	ITEM NO.
81349	RCR07G222JS	6	22	91418	TA01UFPORM35PCT	6	13
81349	RCR07G222JS	8	17	91418	TA01UFPORM35PCT	7	3
81349	RCR07G222JS	13	1	91418	TA01UFPORM35PCT	9	37
81349	RCR07G223JS	10	19	91418	TA01UFPORM35PCT	10	20
81349	RCR07G242JS	7	15	91418	TA01UFPORM35PCT	11	15
81349	RCR07G302JS	6	7	91418	TA01UFPORM35PCT	12	11
81349	RCR07G302JS	7	4	91418	TA01UFPORM35PCT	13	12
81349	RCR07G302JS	9	21	91418	TA01UFPORM35PCT	14	7
81349	RCR07G332JS	7	1	56289	TGS50	9	22
81349	RCR07G333JS	9	40	81349	TS0205P01	3	14
81349	RCR07G362JS	9	17	80058	UG-1094/U	4	23
81349	RCR07G393JS	7	7	80131	1N4742A	12	8
81349	RCR07G393JS	10	5	57177	102-11AL091X	1	52
81349	RCR07G393JS	13	7	74970	111-102	1	16
81349	RCR07G471JS	8	24	74970	111-103	1	17
81349	RCR07G473JS	6	25	80131	2N2646	9	38
81349	RCR07G512JS	7	12	80131	2N5222	7	10
81349	RCR07G512JS	9	24	80294	200P1-501	8	39
81349	RCR07G512JS	11	9	94990	21-24425J01	7	9
81349	RCR07G512JS	13	23	83330	2121	1	8
81349	RCR07G513JS	9	1	02660	225-22221-105	15	1
81349	RCR07G561JS	8	19	83330	2332	6	5
81349	RCR07G621JS	8	27	56289	36D462G015AA2A	4	1
81349	RCR07G622JS	10	14	56289	39D257G030EL4	8	2
81349	RCR07G623JS	9	3	82104	400-3	2	4
81349	RCR07G623JS	10	10	96238	40001213-000	9	26
81349	RCR07G623JS	13	8	96238	40040081-000	3	9
81349	RCR07G681JS	8	12	96238	40040082-001	3	6
81349	RCR07G682JS	6	19	96238	40040082-003	3	8
81349	RCR07G682JS	8	9	96238	40040082-004	3	7
81349	RCR07G682JS	9	7	96238	43000276-000	4	6
81349	RCR07G682JS	10	12	96238	43003041-000	9	29
81349	RCR07G682JS	12	9	96238	46020383-000	1	11
81349	RCR07G682JS	13	2	96238	46020386-000	1	21
81349	RCR07G683JS	9	18	96238	46020388-000	1	10
81349	RCR07G752JS	12	5	96238	46020389-000	1	19
81349	RCR07G822JS	7	14	96238	46020391-000	1	4
81349	RCR20G102JS	9	11	96238	46020397-000	1	20
81349	RCR20G220JS	8	16	96238	46027640-000	1	26
81349	RCR20G680JS	12	7	96238	46027662-000	2	1
81349	RCR20G681JS	8	36	71279	4821-1-0516	4	19
81349	RCR42G390JS	8	7	56289	5GAD10	9	16
81349	RNC55K1501FS	9	5	56289	5GAS15	3	3
81349	RNC55K4530FS	8	25	72619	507-3905-1437-500	1	12
81349	RNC55K6191FS	9	10	72619	515-0012	1	33
81349	RNC55K7320FS	8	28	96238	56025087-000	1	22
81349	RT12C2V201	8	38	96238	57000020-000	3	1
81349	RW67V1R0	8	40	96238	57025147-000	1	18
81349	RW67V332	4	9	75382	599-2004-7	4	26
81349	SE206D02	4	20	96238	61010323000M	1	23
80063	SM-B-525285	10	4	96238	61100118-000	1	60
80063	SM-B-525285	11	7	96238	62000436000K	4	7
80063	SM-B-525285	13	10	96238	62021577000D	1	66
01295	SN158094N	6	9	96238	62021578000D	15	4
01295	SN158099N	6	10	96238	62021578000G	8	44
01295	SN158099N	10	8	96238	62021579000D	1	13
01295	SN158099N	12	12	96238	62021580000D	1	67
01295	SN15830N	10	1	96238	62021582-000	9	30
01295	SN15830N	11	4	96238	62030666000U	4	21
01295	SN15830N	12	15	96238	62030755000A	3	10
01295	SN15830N	13	13	96238	62070226012C	1	39
01295	SN15830N	14	8	96238	62070229000B	1	62
01295	SN15836N	10	2	96238	74000000-002	1	64
01295	SN15836N	11	6	96238	74000054-000	1	45
01295	SN15836N	12	1	74545	7571	1	63
01295	SN15836N	13	16	74545	7595	4	14
01295	SN15836N	14	2	96238	80370292E	5	2
01295	SN15845N	9	15	96238	80372010-000	1	46
01295	SN15846N	6	16	96238	80372012E	6	6
01295	SN15846N	9	14	96238	80372020-000	1	40
01295	SN15846N	10	22	96238	80372022E	8	45
01295	SN15846N	11	3	96238	80372030-000	1	47
01295	SN15846N	12	3	96238	80372032F	9	41
01295	SN15846N	13	11	96238	80372040-000	1	41
01295	SN15846N	14	3	96238	80372042G	10	23
01295	SN15849N	6	15	96238	80372050-000	1	48
01295	SN15862N	13	18	96238	80372052D	11	18
01295	SN159097J	6	18	96238	80372060-000	1	42
01295	SN7492AN	10	21	96238	80372062D	12	16
01295	SN7496N	13	17	96238	80372070-000	1	49

SECTION IV
 TM11-6625-2921-24P/E2137-BV-PLL-060/5103 SG-1054/TO 33A1-8-883-4
 NATIONAL STOCK NUMBER AND PART NUMBER INDEX

FSCM	PART NUMBER	FIGURE NO.	ITEM NO.	FSCM	PART NUMBER	FIGURE NO.	ITEM NO.
96238	80372072G	13	25	96238	80372200-000	1	2
96238	80372080-000	1	43	96238	80372202B	2	8
96238	80372082D	14	10	06540	8232-8-0440	1	59
96238	80372090-000	1	51	83330	8766	1	32
96238	80372180-000	1	50	96238	90372004-000	1	44
96238	80372182B	15	5	962338	90372005-000	1	7
96238	80372190-000	6	4	96238	90372006-000	1	14
96238	80372192D	7	20				

LATEST PART NUMBER ASSIGNMENTS

FSCM	PART NUMBER	FIGURE NO.	ITEM NO.
96238	NO PART NO.-4	1	25

RECOMMENDED CHANGES TO EQUIPMENT TECHNICAL PUBLICATIONS



THEN... JOT DOWN THE DOPE ABOUT IT ON THIS FORM. CAREFULLY TEAR IT OUT. FOLD IT AND DROP IT IN THE MAIL!

SOMETHING WRONG WITH THIS PUBLICATION?

FROM (PRINT YOUR UNIT'S COMPLETE ADDRESS)
 Commander
 Stateside Army Depot
 ATTN: AMSTA-US
 Stateside, N.J. 07703

DATE SENT 10 July 1975

PUBLICATION NUMBER TM 11-5840-340-12	PUBLICATION DATE 23 Jan 74	PUBLICATION TITLE Radar Set AN/PRC-76
---	-------------------------------	--

BE EXACT... PIN-POINT WHERE IT IS				IN THIS SPACE TELL WHAT IS WRONG AND WHAT SHOULD BE DONE ABOUT IT:
PAGE NO	PARA-GRAPH	FIGURE NO	TABLE NO	
2-25	2-28			<p>Recommend that the installation antenna alignment procedure be changed throughout to specify a 2° IFF antenna lag rather than 1°.</p> <p>REASON: Experience has shown that with only a 1° lag, the antenna servo system is too sensitive to wind gusting in excess of 25 knots, and has a tendency to rapidly accelerate and decelerate as it hunts, causing strain to the drive train. Hunting is minimized by adjusting the lag to 2° without degradation of operation.</p>
3-10	3-3		3-1	<p>Item 5, Function column. Change "2 db" to "3db."</p> <p>REASON: The adjustment procedure the the TRANS POWER FAULT indicator calls for a 3 db (500 watts) adjustment to light the TRANS POWER FAULT indicator.</p>
5-6	5-8			<p>Add new step f.1 to read, "Replace cover plate removed in step e.1, above."</p> <p>REASON: To replace the cover plate.</p>
		F03		<p>Zone C 3. On J1-2, change "+24 VDC to "+5 VDC."</p> <p>REASON: This is the output line of the 5 VDC power supply. +24 VDC is the input voltage.</p>

PRINTED NAME, GRADE OR TITLE, AND TELEPHONE NUMBER
 SSG I. M. DeSpirito 999-1776

SIGN HERE

TEAR ALONG PERFORATED LINE

RECOMMENDED CHANGES TO EQUIPMENT TECHNICAL PUBLICATIONS



THEN...JOT DOWN THE DOPE ABOUT IT ON THIS FORM. CAREFULLY TEAR IT OUT, FOLD IT AND DROP IT IN THE MAIL.

SOMETHING WRONG WITH THIS PUBLICATION?

FROM: (PRINT YOUR UNIT'S COMPLETE ADDRESS)

DATE SENT

PUBLICATION NUMBER

TM 11-6625-2921-24P

PUBLICATION DATE

15 Nov 82

PUBLICATION TITLE Signal Generator

SG-1054/G

BE EXACT PIN-POINT WHERE IT IS

PAGE NO.	PARA-GRAPH	FIGURE NO.	TABLE NO.

IN THIS SPACE TELL WHAT IS WRONG AND WHAT SHOULD BE DONE ABOUT IT:

TEAR ALONG PERFORATED LINE

PRINTED NAME GRADE OR TITLE AND TELEPHONE NUMBER

SIGN HERE

DA FORM 2028-2 JUL 79

PREVIOUS EDITIONS ARE OBSOLETE

P.S.--IF YOUR OUTFIT WANTS TO KNOW ABOUT YOUR RECOMMENDATION MAKE A CARBON COPY OF THIS AND GIVE IT TO YOUR HEADQUARTERS.

FILL IN YOUR
UNIT'S ADDRESS

FOLD BACK

DEPARTMENT OF THE ARMY

OFFICIAL BUSINESS

Commander
US Army Communications-
Electronics Command
ATTN: DRSEL-ME-MP
Fort Monmouth, New Jersey 07703

TEAR ALONG PERFORATED LINE

RECOMMENDED CHANGES TO EQUIPMENT TECHNICAL PUBLICATIONS



THEN...JOT DOWN THE DOPE ABOUT IT ON THIS FORM. CAREFULLY TEAR IT OUT, FOLD IT AND DROP IT IN THE MAIL.

SOMETHING WRONG WITH THIS PUBLICATION?

FROM: (PRINT YOUR UNIT'S COMPLETE ADDRESS)

DATE SENT

PUBLICATION NUMBER
TM 11-6625-2921-24P

PUBLICATION DATE
15 Nov 82

PUBLICATION TITLE Signal Generator
SG-1054/G

BE EXACT PIN-POINT WHERE IT IS

PAGE NO.	PARA-GRAPH	FIGURE NO.	TABLE NO.

IN THIS SPACE TELL WHAT IS WRONG AND WHAT SHOULD BE DONE ABOUT IT:

TEAR ALONG PERFORATED LINE

PRINTED NAME GRADE OR TITLE AND TELEPHONE NUMBER

SIGN HERE

DA FORM 2028-2
1 JUL 79

PREVIOUS EDITIONS ARE OBSOLETE

P.S.--IF YOUR OUTFIT WANTS TO KNOW ABOUT YOUR RECOMMENDATION MAKE A CARBON COPY OF THIS AND GIVE IT TO YOUR HEADQUARTERS.

FILL IN YOUR
UNIT'S ADDRESS

FOLD BACK

DEPARTMENT OF THE ARMY

OFFICIAL BUSINESS

Commander
US Army Communications-
Electronics Command
ATTN: DRSEL-ME-MP
Fort Monmouth, New Jersey 07703

TEAR ALONG PERFORATED LINE

RECOMMENDED CHANGES TO EQUIPMENT TECHNICAL PUBLICATIONS



SOMETHING WRONG WITH THIS PUBLICATION?

THEN...JOT DOWN THE DOPE ABOUT IT ON THIS FORM. CAREFULLY TEAR IT OUT, FOLD IT AND DROP IT IN THE MAIL.

FROM: (PRINT YOUR UNIT'S COMPLETE ADDRESS)

DATE SENT

PUBLICATION NUMBER

TM 11-6625-2921-24P

PUBLICATION DATE

15 Nov 82

PUBLICATION TITLE Signal Generator

SG-1054/G

BE EXACT PIN-POINT WHERE IT IS

PAGE NO.

PARA-GRAPH

FIGURE NO.

TABLE NO.

IN THIS SPACE TELL WHAT IS WRONG AND WHAT SHOULD BE DONE ABOUT IT:

TEAR ALONG PERFORATED LINE

PRINTED NAME GRADE OR TITLE AND TELEPHONE NUMBER

SIGN HERE

DA FORM 2028-2
JUL 79

PREVIOUS EDITIONS ARE OBSOLETE

P.S.--IF YOUR OUTFIT WANTS TO KNOW ABOUT YOUR RECOMMENDATION MAKE A CARBON COPY OF THIS AND GIVE IT TO YOUR HEADQUARTERS.

FILL IN YOUR
UNIT'S ADDRESS

FOLD BACK

DEPARTMENT OF THE ARMY

OFFICIAL BUSINESS

Commander
US Army Communications-
Electronics Command
ATTN: DRSEL-ME-MP
Fort Monmouth, New Jersey 07703

TEAR ALONG PERFORATED LINE

By Order of the Secretaries of the Army, the Navy, and the Air Force:

E. C. MEYER

General United States Army

Chief of Staff

Official:

ROBERT M. JOYCE

Major General, United States Army

The Adjutant General

H. D. ARNOLD

Rear Admiral United States Navy

Commander, Naval Electronic

Systems Command

Official:

CHARLES A. GABRIEL, *General USAF*

Chief of Staff

JAMES L. WYATT, JR.

Colonel, USAF Director of Administration

Distribution:

To be distributed in accordance with Special Mailing List.

